

LAND AND PROPERTY INFORMATION NEW SOUTH WALES - TITLE SEARCH
-----FOLIO: AUTO CONSOL 11602-242

SEARCH DATE	TIME	EDITION NO	DATE
-----	----	-----	----
25/11/2016	2:06 PM	7	1/7/2002

LAND
-----LAND DESCRIBED IN SCHEDULE OF PARCELS
LOCAL GOVERNMENT AREA BYRON
PARISH OF BYRON COUNTY OF ROUS
TITLE DIAGRAM DP1623FIRST SCHEDULE

STEWARTVILLE PTY LTD (T 5410310)

SECOND SCHEDULE (18 NOTIFICATIONS)

- 1 LAND EXCLUDES MINERALS AND IS SUBJECT TO RESERVATIONS AND
CONDITIONS IN FAVOUR OF THE CROWN - SEE CROWN GRANT(S)
- 2 D379110 RIGHT OF WAY AFFECTING THE PART OF LOTS 32 & 33 OF
SEC 3 IN DP1623 SHOWN IN PLAN WITH D379110
- 3 D432499 RIGHT OF WAY AFFECTING THE PART OF LOTS 32 & 33 OF
SEC 3 IN DP1623 SHOWN IN PLAN WITH D379110
- 4 D470483 RIGHT OF WAY AFFECTING THE PART OF LOTS 32 & 33 OF
SEC 3 IN DP1623 SHOWN IN PLAN WITH D379110
- 5 D508059 RIGHT OF WAY AFFECTING THE PART OF LOTS 32 & 33 OF
SEC 3 IN DP1623 SHOWN IN PLAN WITH D379110
- 6 D931181 RIGHT OF WAY AFFECTING THE PART OF LOTS 32 & 33 OF
SEC 3 IN DP1623 SHOWN IN PLAN WITH D379110
- 7 M9797 RIGHT OF WAY AFFECTING THE PART OF LOTS 32 & 33
OF SEC 3 IN DP1623 SHOWN IN PLAN WITH D379110
- 8 D379110 RIGHT OF WAY APPURTENANT TO THE LAND ABOVE
DESCRIBED AFFECTING THE PART OF LOTS 13 & 14 OF SEC 3
IN DP1623 SHOWN IN PLAN WITH D379110
- 9 D432499 RIGHT OF WAY APPURTENANT TO THE LAND ABOVE
DESCRIBED AFFECTING THE PART OF LOTS 11 & 12 OF SEC 3
IN DP1623 SHOWN IN PLAN WITH D379110
- 10 D470483 RIGHT OF WAY APPURTENANT TO THE LAND ABOVE
DESCRIBED AFFECTING THE PART OF LOTS 15-19 OF SEC 3 IN
DP1623 SHOWN IN PLAN WITH D379110
- 11 D508059 RIGHT OF WAY APPURTENANT TO THE LAND ABOVE
DESCRIBED AFFECTING THE PART OF LOTS 20-24 OF SEC 3 IN
DP1623 SHOWN IN PLAN WITH D379110
- 12 D931181 RIGHT OF WAY APPURTENANT TO THE LAND ABOVE
DESCRIBED AFFECTING THE PART OF LOTS 1 & 2, 25-31 &
37-69 OF SEC 3 IN DP1623 SHOWN IN PLAN WITH D379110
- 13 M9797 RIGHT OF WAY APPURTENANT TO THE LAND ABOVE

END OF PAGE 1 - CONTINUED OVER

PRINTED ON 25/11/2016

FOLIO: AUTO CONSOL 11602-242

PAGE 2

SECOND SCHEDULE (18 NOTIFICATIONS) (CONTINUED)

		DESCRIBED AFFECTING THE PART OF LOTS 35 & 36 OF SEC 3 IN DP1623 SHOWN IN PLAN WITH D379110
14	DP266246	RIGHT OF CARRIAGEWAY (A) VARIABLE WIDTH AFFECTING THE PART OF LOT 33 OF SEC 3 IN DP1623 SHOWN IN DP266246
15	DP266246	RIGHT OF CARRIAGEWAY (B) VARIABLE WIDTH APPURTENANT TO LOT 33 OF SEC 3 IN DP1623
16	DP266246	EASEMENT FOR FENCING & GARDENING VARIABLE WIDTH APPURTENANT TO LOTS 32 & 33 OF SEC 3 IN DP1623
17	DP268951	RIGHT OF CARRIAGEWAY AND EASEMENT FOR SERVICES 10.06 WIDE AFFECTING THE PART(S) SHOWN SO BURDENED IN DP268951
18	8455016	RIGHT OF CARRIAGEWAY VARIABLE WIDTH APPURTENANT TO THE LAND ABOVE DESCRIBED AFFECTING THE PART OF LOT 2 SEC. 3 IN DP1623 AS SHOWN IN DP1039659

NOTATIONS

NOTE: THE CERTIFICATE OF TITLE FOR THIS FOLIO OF THE REGISTER DOES
NOT INCLUDE SECURITY FEATURES INCLUDED ON COMPUTERISED
CERTIFICATES OF TITLE ISSUED FROM 4TH JANUARY, 2004. IT IS
RECOMMENDED THAT STRINGENT PROCESSES ARE ADOPTED IN VERIFYING THE
IDENTITY OF THE PERSON(S) CLAIMING A RIGHT TO DEAL WITH THE LAND
COMPRISED IN THIS FOLIO.

UNREGISTERED DEALINGS: NIL

SCHEDULE OF PARCELS

LOTS 32-33 SEC. 3 IN DP1623.

*** END OF SEARCH ***

PRINTED ON 25/11/2016

* Any entries preceded by an asterisk do not appear on the current edition of the Certificate of Title. Warning: the information appearing under notations
has not been formally recorded in the Register.

© State of New South Wales through Land and Property Information (2016)

SAI Global Property Division an approved NSW Information Broker hereby certifies that the information contained in this document has been provided
electronically by the Registrar General in accordance with section 96B(2) of the Real Property Act 1900.

LAND AND PROPERTY INFORMATION NEW SOUTH WALES - TITLE SEARCH

FOLIO: AUTO CONSOL 11602-242

SEARCH DATE -----	TIME -----	EDITION NO -----	DATE -----
25/11/2016	2:06 PM	7	1/7/2002

LAND

LAND DESCRIBED IN SCHEDULE OF PARCELS
LOCAL GOVERNMENT AREA BYRON
PARISH OF BYRON COUNTY OF ROUS
TITLE DIAGRAM DP1623

FIRST SCHEDULE

STEWARTVILLE PTY LTD (T 5410310)

SECOND SCHEDULE (18 NOTIFICATIONS)

- 1 LAND EXCLUDES MINERALS AND IS SUBJECT TO RESERVATIONS AND
CONDITIONS IN FAVOUR OF THE CROWN - SEE CROWN GRANT(S)
- 2 D379110 RIGHT OF WAY AFFECTING THE PART OF LOTS 32 & 33 OF
SEC 3 IN DP1623 SHOWN IN PLAN WITH D379110
- 3 D432499 RIGHT OF WAY AFFECTING THE PART OF LOTS 32 & 33 OF
SEC 3 IN DP1623 SHOWN IN PLAN WITH D379110
- 4 D470483 RIGHT OF WAY AFFECTING THE PART OF LOTS 32 & 33 OF
SEC 3 IN DP1623 SHOWN IN PLAN WITH D379110
- 5 D508059 RIGHT OF WAY AFFECTING THE PART OF LOTS 32 & 33 OF
SEC 3 IN DP1623 SHOWN IN PLAN WITH D379110
- 6 D931181 RIGHT OF WAY AFFECTING THE PART OF LOTS 32 & 33 OF
SEC 3 IN DP1623 SHOWN IN PLAN WITH D379110
- 7 M9797 RIGHT OF WAY AFFECTING THE PART OF LOTS 32 & 33
OF SEC 3 IN DP1623 SHOWN IN PLAN WITH D379110
- 8 D379110 RIGHT OF WAY APPURTENANT TO THE LAND ABOVE
DESCRIBED AFFECTING THE PART OF LOTS 13 & 14 OF SEC 3
IN DP1623 SHOWN IN PLAN WITH D379110
- 9 D432499 RIGHT OF WAY APPURTENANT TO THE LAND ABOVE
DESCRIBED AFFECTING THE PART OF LOTS 11 & 12 OF SEC 3
IN DP1623 SHOWN IN PLAN WITH D379110
- 10 D470483 RIGHT OF WAY APPURTENANT TO THE LAND ABOVE
DESCRIBED AFFECTING THE PART OF LOTS 15-19 OF SEC 3 IN
DP1623 SHOWN IN PLAN WITH D379110
- 11 D508059 RIGHT OF WAY APPURTENANT TO THE LAND ABOVE
DESCRIBED AFFECTING THE PART OF LOTS 20-24 OF SEC 3 IN
DP1623 SHOWN IN PLAN WITH D379110
- 12 D931181 RIGHT OF WAY APPURTENANT TO THE LAND ABOVE
DESCRIBED AFFECTING THE PART OF LOTS 1 & 2, 25-31 &
37-69 OF SEC 3 IN DP1623 SHOWN IN PLAN WITH D379110
- 13 M9797 RIGHT OF WAY APPURTENANT TO THE LAND ABOVE

END OF PAGE 1 - CONTINUED OVER

PRINTED ON 25/11/2016

FOLIO: AUTO CONSOL 11602-242

PAGE 2

SECOND SCHEDULE (18 NOTIFICATIONS) (CONTINUED)

		DESCRIBED AFFECTING THE PART OF LOTS 35 & 36 OF SEC 3 IN DP1623 SHOWN IN PLAN WITH D379110
14	DP266246	RIGHT OF CARRIAGEWAY (A) VARIABLE WIDTH AFFECTING THE PART OF LOT 33 OF SEC 3 IN DP1623 SHOWN IN DP266246
15	DP266246	RIGHT OF CARRIAGEWAY (B) VARIABLE WIDTH APPURTENANT TO LOT 33 OF SEC 3 IN DP1623
16	DP266246	EASEMENT FOR FENCING & GARDENING VARIABLE WIDTH APPURTENANT TO LOTS 32 & 33 OF SEC 3 IN DP1623
17	DP268951	RIGHT OF CARRIAGEWAY AND EASEMENT FOR SERVICES 10.06 WIDE AFFECTING THE PART(S) SHOWN SO BURDENED IN DP268951
18	8455016	RIGHT OF CARRIAGEWAY VARIABLE WIDTH APPURTENANT TO THE LAND ABOVE DESCRIBED AFFECTING THE PART OF LOT 2 SEC. 3 IN DP1623 AS SHOWN IN DP1039659

NOTATIONS

NOTE: THE CERTIFICATE OF TITLE FOR THIS FOLIO OF THE REGISTER DOES
NOT INCLUDE SECURITY FEATURES INCLUDED ON COMPUTERISED
CERTIFICATES OF TITLE ISSUED FROM 4TH JANUARY, 2004. IT IS
RECOMMENDED THAT STRINGENT PROCESSES ARE ADOPTED IN VERIFYING THE
IDENTITY OF THE PERSON(S) CLAIMING A RIGHT TO DEAL WITH THE LAND
COMPRISED IN THIS FOLIO.

UNREGISTERED DEALINGS: NIL

SCHEDULE OF PARCELS

LOTS 32-33 SEC. 3 IN DP1623.

*** END OF SEARCH ***

PRINTED ON 25/11/2016

* Any entries preceded by an asterisk do not appear on the current edition of the Certificate of Title. Warning: the information appearing under notations
has not been formally recorded in the Register.

© State of New South Wales through Land and Property Information (2016)

SAI Global Property Division an approved NSW Information Broker hereby certifies that the information contained in this document has been provided
electronically by the Registrar General in accordance with section 96B(2) of the Real Property Act 1900.

LAND AND PROPERTY INFORMATION NEW SOUTH WALES - TITLE SEARCH
-----FOLIO: 34/3/1623

SEARCH DATE	TIME	EDITION NO	DATE
-----	----	-----	----
13/12/2016	2:52 PM	6	5/11/2015

LAND
-----LOT 34 OF SECTION 3 IN DEPOSITED PLAN 1623
LOCAL GOVERNMENT AREA BYRON
PARISH OF BYRON COUNTY OF ROUS
TITLE DIAGRAM DP1623FIRST SCHEDULE

MARIA TERESA BADALOTTI (T AJ955507)

SECOND SCHEDULE (19 NOTIFICATIONS)

- 1 LAND EXCLUDES MINERALS AND IS SUBJECT TO RESERVATIONS AND
CONDITIONS IN FAVOUR OF THE CROWN - SEE CROWN GRANT(S)
- 2 D379110 RIGHT OF WAY AFFECTING THE PART OF THE LAND ABOVE
DESCRIBED SHOWN IN PLAN WITH D379110
- 3 D432499 RIGHT OF WAY AFFECTING THE PART OF THE LAND ABOVE
DESCRIBED SHOWN IN PLAN WITH D379110
- 4 D470483 RIGHT OF WAY AFFECTING THE PART OF THE LAND ABOVE
DESCRIBED SHOWN IN PLAN WITH D379110
- 5 D508059 RIGHT OF WAY AFFECTING THE PART OF THE LAND ABOVE
DESCRIBED SHOWN IN PLAN WITH D379110
- 6 D931181 RIGHT OF WAY AFFECTING THE PART OF THE LAND ABOVE
DESCRIBED SHOWN IN PLAN WITH D379110
- 7 M9797 RIGHT OF WAY AFFECTING THE PART OF THE LAND ABOVE
DESCRIBED SHOWN IN PLAN WITH D379110
- 8 D379110 RIGHT OF WAY APPURTENANT TO THE LAND ABOVE
DESCRIBED AFFECTING THE PART OF LOTS 13 & 14 OF SEC 3
IN DP1623 SHOWN IN PLAN WITH D379110
- 9 D432499 RIGHT OF WAY APPURTENANT TO THE LAND ABOVE
DESCRIBED AFFECTING THE PART OF LOTS 11 & 12 OF SEC 3
IN DP1623 SHOWN IN PLAN WITH D379110
- 10 D470483 RIGHT OF WAY APPURTENANT TO THE LAND ABOVE
DESCRIBED AFFECTING THE PART OF LOTS 15-19 OF SEC 3 IN
DP1623 SHOWN IN PLAN WITH D379110
- 11 D508059 RIGHT OF WAY APPURTENANT TO THE LAND ABOVE
DESCRIBED AFFECTING THE PART OF LOTS 20-24 OF SEC 3 IN
DP1623 SHOWN IN PLAN WITH D379110
- 12 D931181 RIGHT OF WAY APPURTENANT TO THE LAND ABOVE
DESCRIBED AFFECTING THE PART OF LOTS 1 & 2, 25-31 &
37-69 OF SEC 3 IN DP1623 SHOWN IN PLAN WITH D379110
- 13 M9797 RIGHT OF WAY APPURTENANT TO THE LAND ABOVE

END OF PAGE 1 - CONTINUED OVER

PRINTED ON 13/12/2016

FOLIO: 34/3/1623

PAGE 2

SECOND SCHEDULE (19 NOTIFICATIONS) (CONTINUED)

DESCRIBED AFFECTING THE PART OF LOTS 35 & 36 OF SEC 3
IN DP1623 SHOWN IN PLAN WITH D379110

14	DP266246	RIGHT OF CARRIAGEWAY (A) VARIABLE WIDTH APPURTENANT TO THE LAND ABOVE DESCRIBED
15	DP266246	RIGHT OF CARRIAGEWAY (B) VARIABLE WIDTH AFFECTING THE PART OF THE LAND ABOVE DESCRIBED SHOWN IN DP266246
16	DP266246	EASEMENT FOR FENCING & GARDENING VARIABLE WIDTH AFFECTING THE PART OF THE LAND ABOVE DESCRIBED SHOWN IN DP266246
17	DP266246	RESTRICTION(S) ON THE USE OF LAND
18	DP268951	RIGHT OF CARRIAGEWAY AND EASEMENT FOR SERVICES 10.06 WIDE APPURTENANT TO THE LAND ABOVE DESCRIBED
19	9471559	RESTRICTION AS TO USER (S.88E(3) CONVEYANCING ACT, 1919)

NOTATIONS

8496992 NOTE: SUBJECT TO ORDER OF COURT DATED 5-5-1999. COPY FILED
WITH 8496992.

UNREGISTERED DEALINGS: NIL

*** END OF SEARCH ***

PRINTED ON 13/12/2016

* Any entries preceded by an asterisk do not appear on the current edition of the Certificate of Title. Warning: the information appearing under notations has not been formally recorded in the Register.

© State of New South Wales through Land and Property Information (2016)

SAI Global Property Division an approved NSW Information Broker hereby certifies that the information contained in this document has been provided electronically by the Registrar General in accordance with section 96B(2) of the Real Property Act 1900.

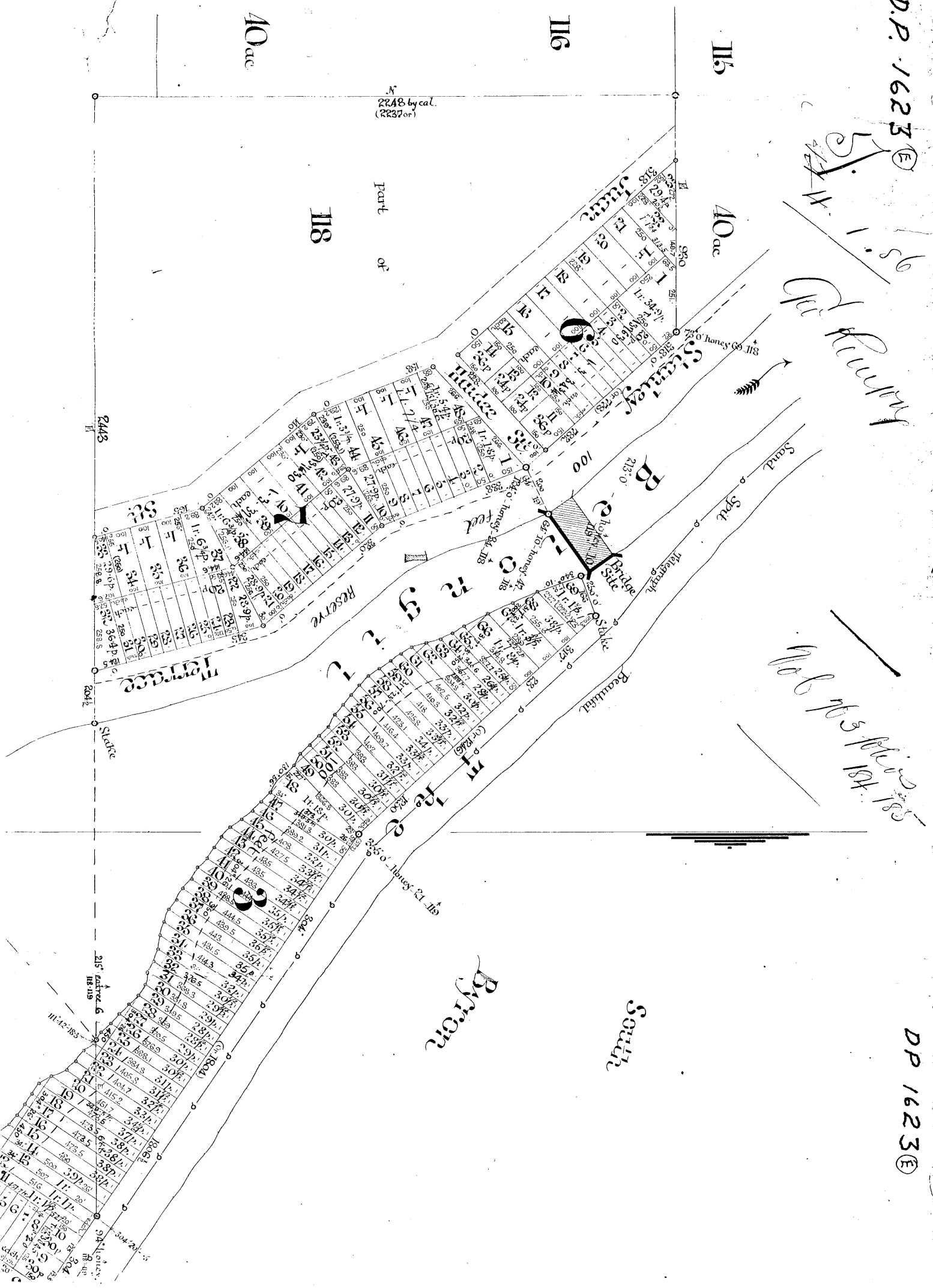

J. P.
Sturges

1988

Township
7.112231
1.1.15 1/2

and a honey - 19 - 118

Living

L

1623

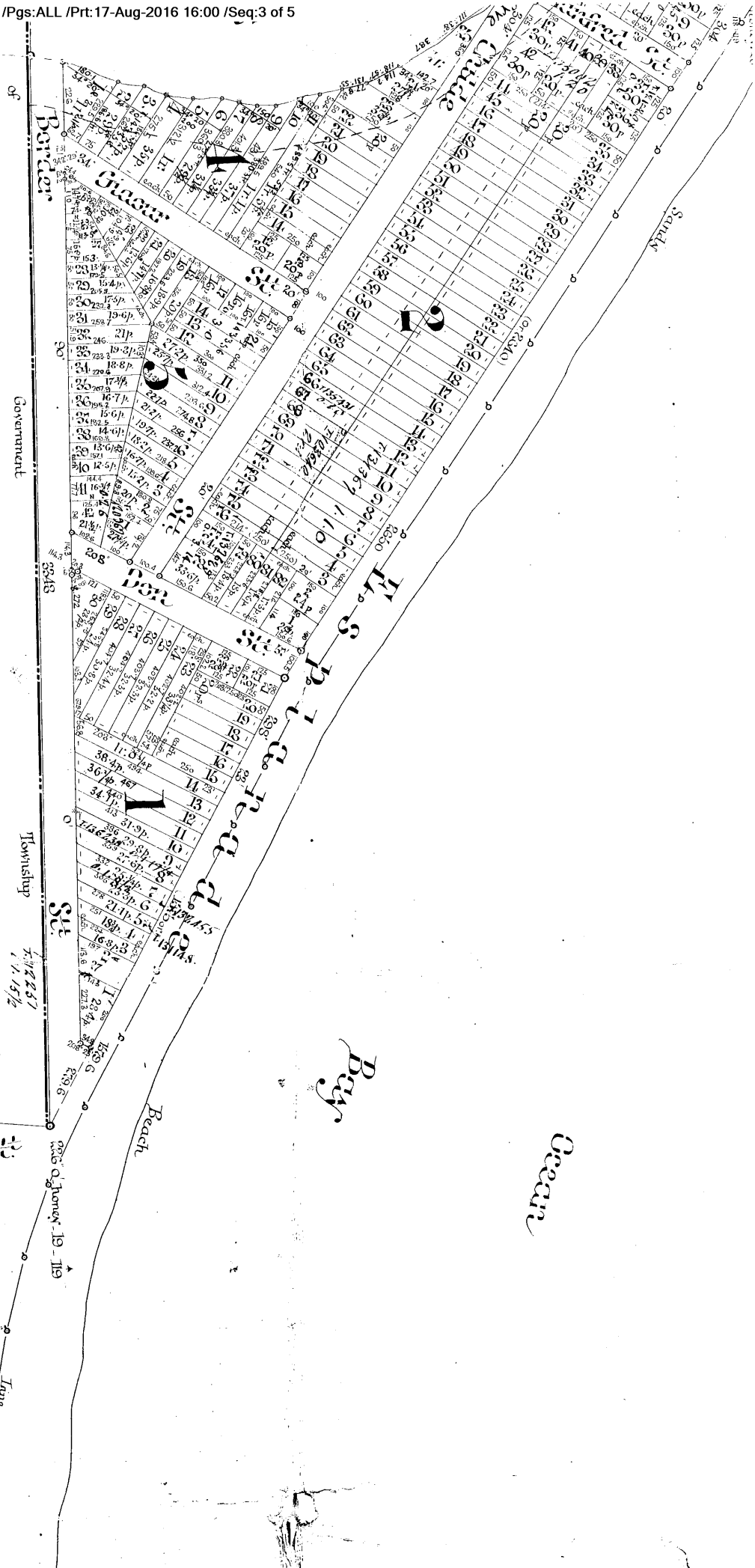

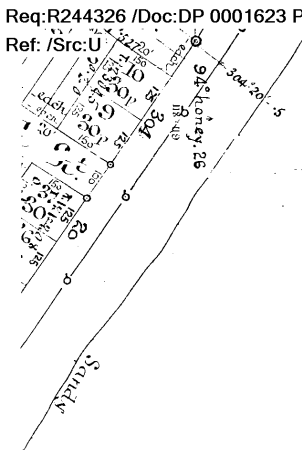

"A"

PLAN

of Subdivision of part of parcel 118 and 119.

Parrish of Byron

County of Pecos

The Property of Nathaniel Simmons.

1 50 ac per 118 Grant to Nathaniel Julian Simmons 30th Dec 1885 1676360 184
2 50 ac " 119 " Nathaniel Julian Simmons 30th Dec 1885 " 765 " 185

1623

DP 1623

DP 1623 (E)

COPY MADE BY M. J. 15.1.89
NATHANIEL JULIAN SIMMONS 4.2.89

1623

