

7.0 MASTERPLAN

The following masterplan provides a concept of the possible longterm layout and design of the Park.

The concept is principally intended to enhance the appreciation of the opportunities that the area can afford and provides one illustration of a long term scenario for the Park, illustrating many of the strategies outlined in this Plan.

The concepts will require further refinement through design development as part of the implementation phases, if sanctioned by NPWS and the various stakeholders.

Two detailed areas are also illustrated (Refer Figs. 13 and 14) providing a preliminary concept of the possible layout and design of two key sites within the Park including:

- Girrahween Park
- Turrella Reserve

The design areas encompass particular locations in the Park where many of the strategies outlined in this Plan are integrated.

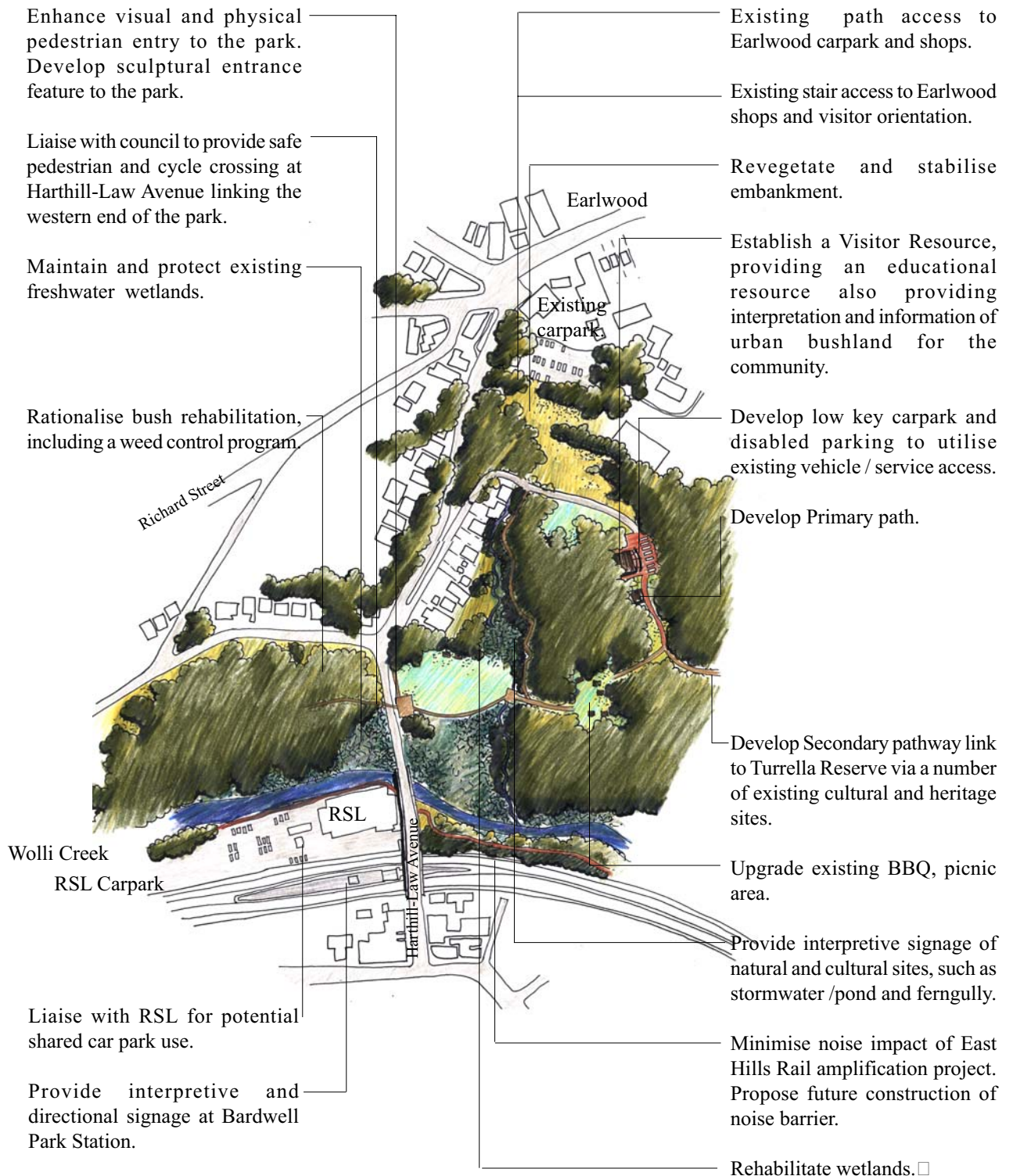

**FIGURE 13
GIRRAHWEEN PARK DETAIL
AREA**

LEGEND

-  CONTOURS
-  WOOLLY CREEK
-  PRINCIPAL ENTRANCE / VISITOR CENTRE FACILITIES AND FOCUS INCLUDING ORIENTATION / INFORMATION / INTERPRETATION
-  MINOR PARK ENTRANCES INCLUDING ORIENTATION / INFORMATION / INTERPRETATION
-  PICNIC & BBQ SHELTERS / TOILET FACILITIES / PLAY AREAS
-  PROPOSED BUILDINGS
-  IMPROVED BUSHLAND AREAS
-  CREEK VEGETATION / REED BEDS / WETLANDS / RIPARIAN
-  OPEN GRASSLAND AREAS
-  IDENTITY PLANTING
-  PEDESTRIAN PATH SYSTEM
-  BOARDWALK

RABBIT GOAT HILL
Maintain and enhance panoramic views across park valley and greater western Sydney suburbs.

TERTIARY PATH
Establish a rough bushtrack, offroad grade path on the existing maintained and established track.

LINE WITH BIRCHILL CREEK VALLEY
Provide information and directional signage showing links to Wall Creek Regional Park.

TURRELLA RESERVE
Improve the existing open space area through tree planting. Encourage recreational activities including bushwalk, kite flying and picnicking.

MAJOR VISITOR FOCUS TURRELLA RESERVE
Develop as a recreational parkland focusing on family events and activities. Planting areas with diverse landscape opportunities. BGC's picnic shelter and picnic areas, amenities, solar facilities, and interpretive signage.
Provide improved natural habitat including:
- Structural tree planting
- Increased reed beds
- Native grasses
- Differential mowing regime
- Signage to encourage visitors to explore bushland

PRIMARY PATH
Establish easy grade path for disabled access.
Provide service vehicle and potential event parking for events in the reserve.
Area for consolidation at top of bush area.
The path to the quarry will generally follow the route of the existing path subject to environmental constraints.

TURRELLA STATION
Provide interpretive and directional signage at the station to encourage increased use. Improve quality of street access to Turrella Reserve.

HEARTLAND FEATURES
Incorporate cultural and natural heritage features, such as Farnquhar, Henderson Street Wall, the Sandstone Outcrop and "Swimming Pool".

SECONDARY PATH
Establish easy to maintain grade path using diverse plant communities and cultural and natural heritage sites.

HERITAGE SITES
Integrate heritage sites, such as Jackson Floor Cottages, the Quarry and Market Gardens.

TERTIARY PATH
Establish a rough bushtrack, offroad grade path on the existing maintained and established track.

TEMPLE STATION
Provide information and directional signage at the station to encourage increased use of the park.

Station and entrance relating internal connections to Clarke River, Quary Bay and Temple Station.

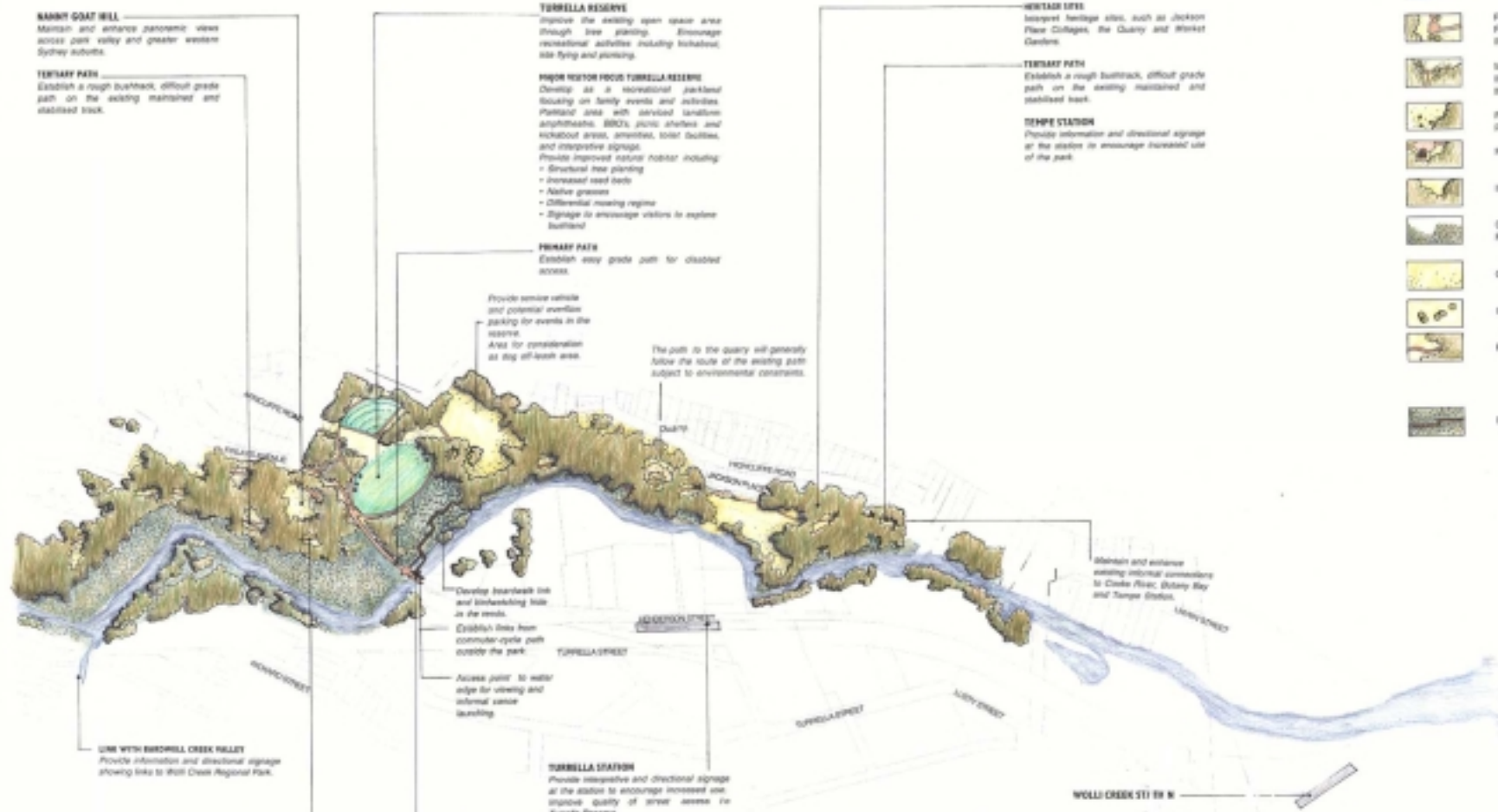

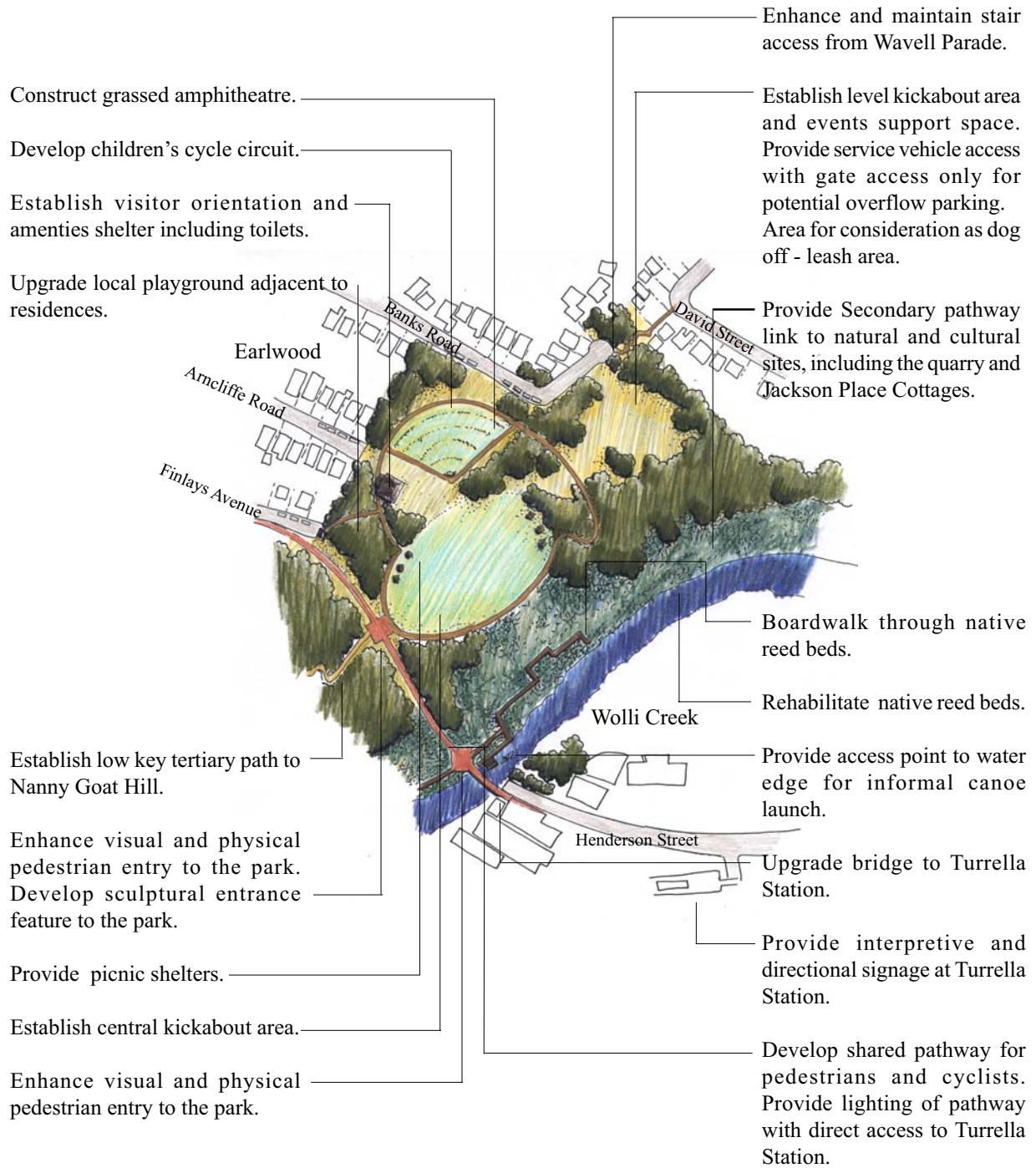

**FIGURE 14
TURRELLA DETAILED AREA**

7.1 PLANNING AND DESIGN PRINCIPLES

Masterplan

A concept design to illustrate many of the key proposals in the Plan of Management.

Planning and Design Principles

An outline of some planning and design guidelines applicable to specific locations or situations within the Park.

Continuing management and development of the site should aim for a high standard of appearance and aesthetic control in all construction. To this end, the following guidelines suggest materials, techniques and details that are suitable for Wolli Creek Regional Park and include structures, planting and pollution control measures.

The following details are guidelines only and cannot be applied without specific site investigation and detailed design. They are intended to demonstrate the scale, character and relative impacts of appropriate treatments.

Refer also to Planning and Management strategies for relevant ESD principles in design development and construction.

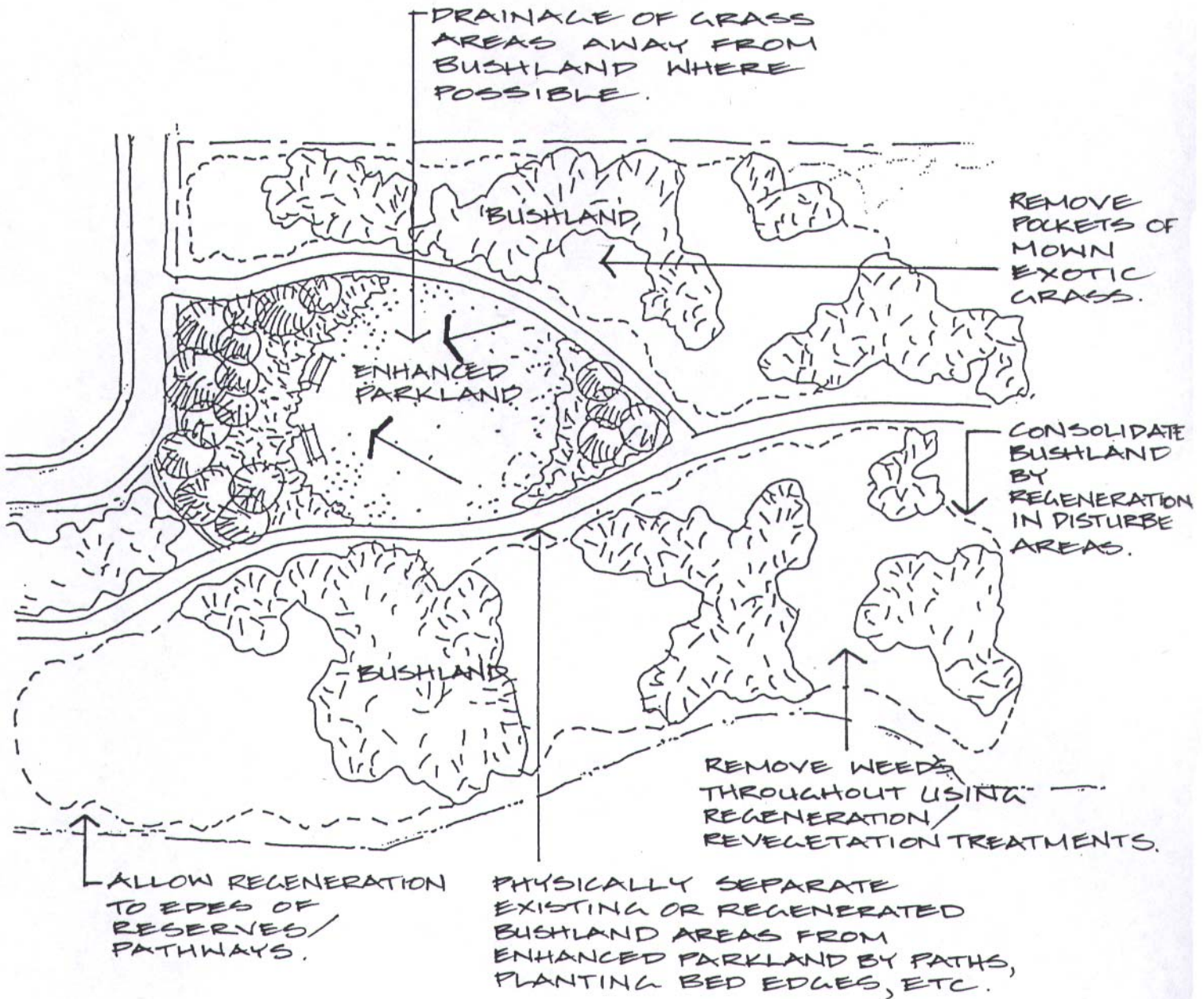

**FIGURE 15
PRINCIPLES FOR
CONSOLIDATING NATIVE
BUSHLAND**

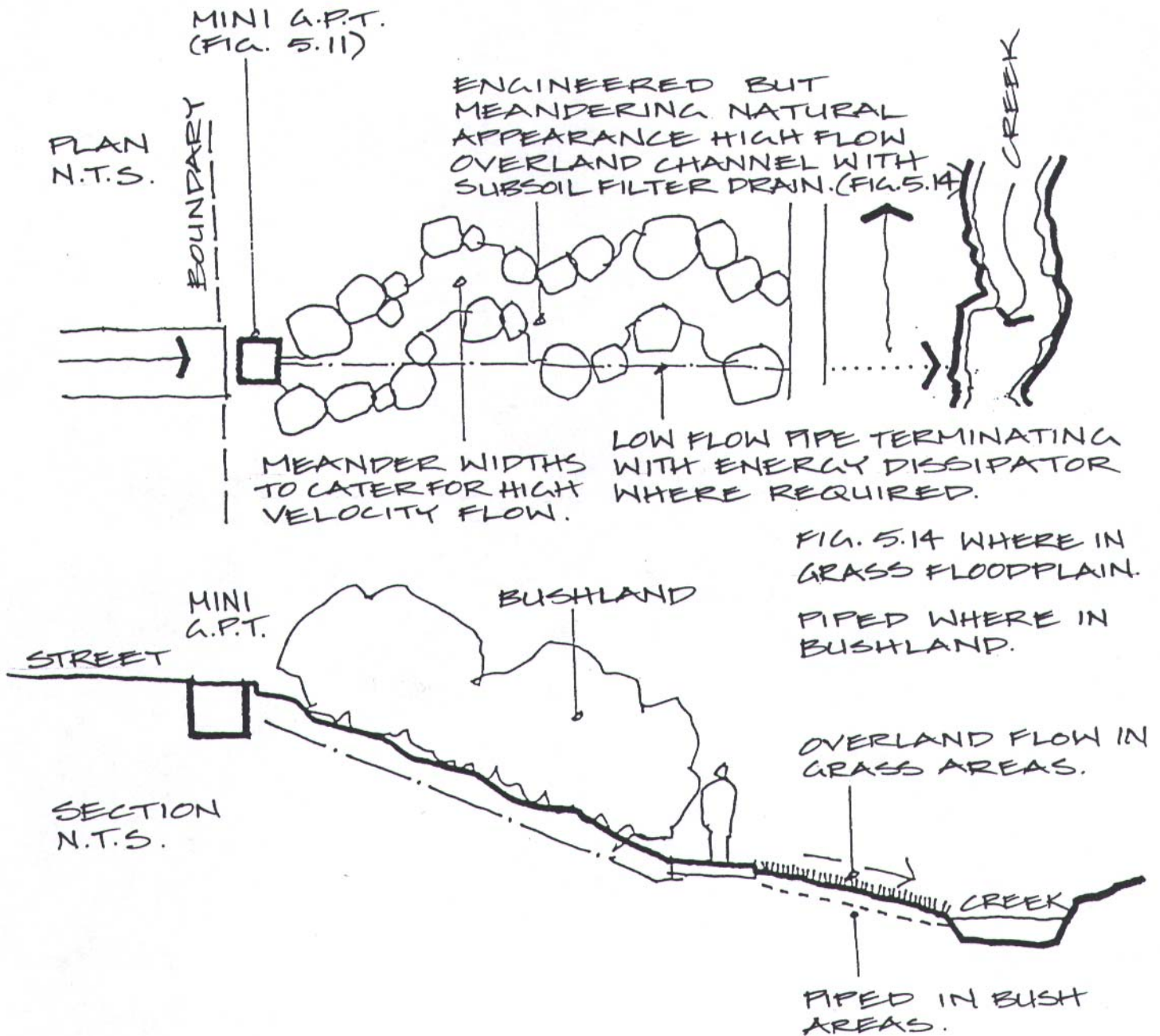
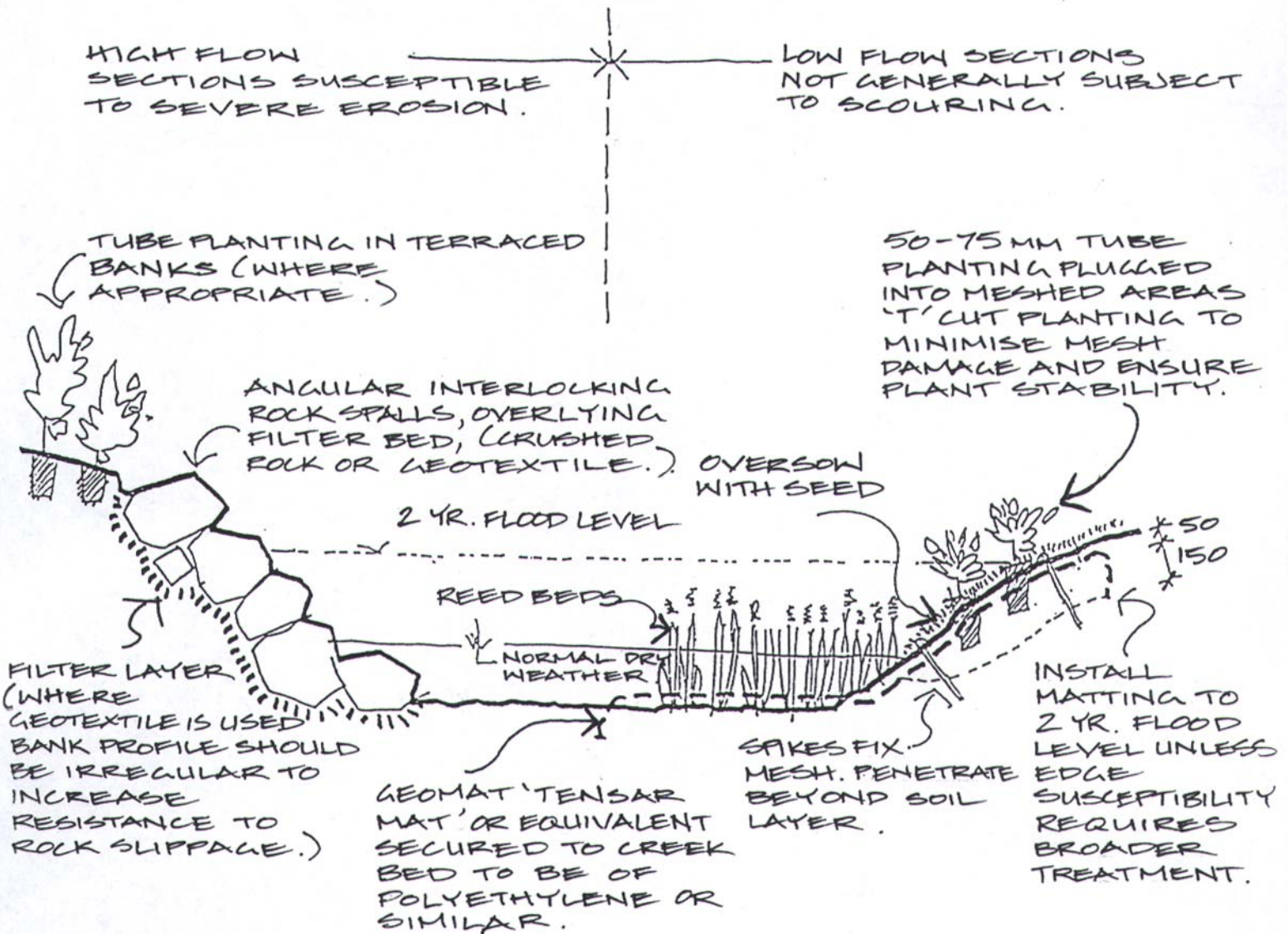
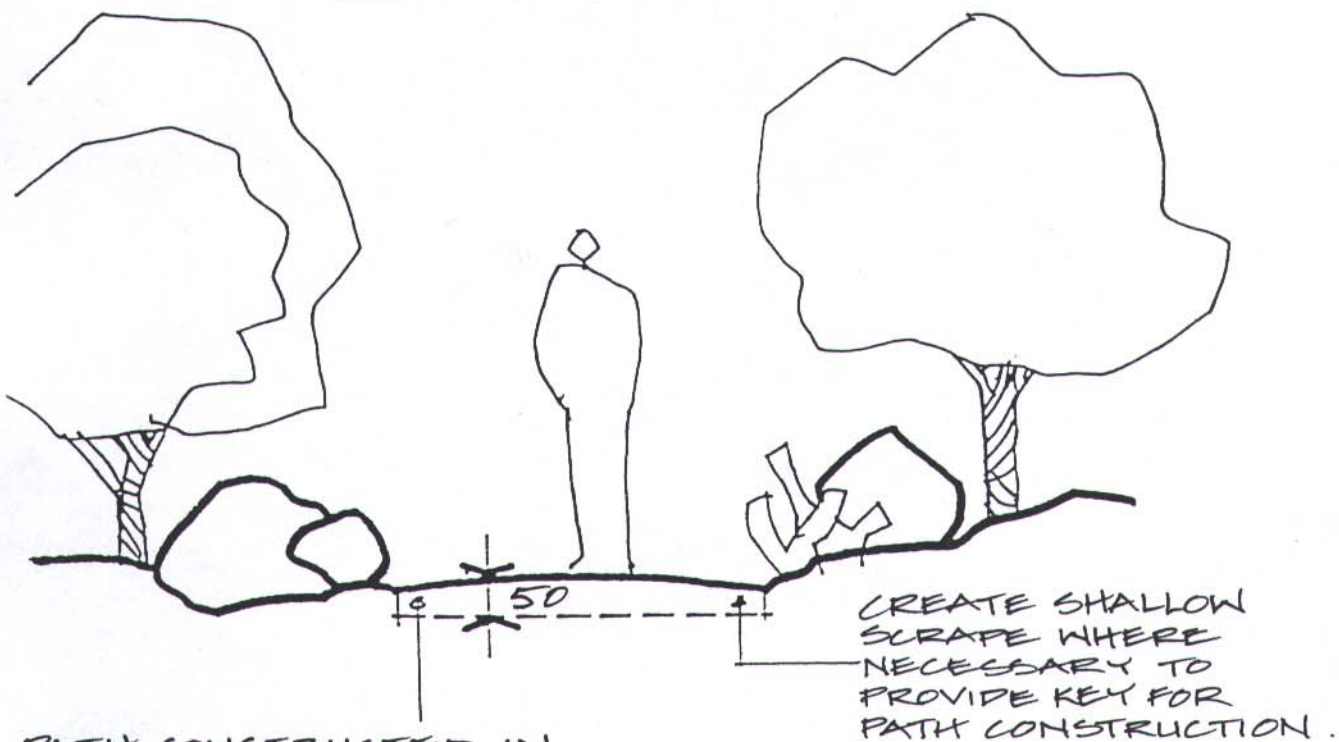
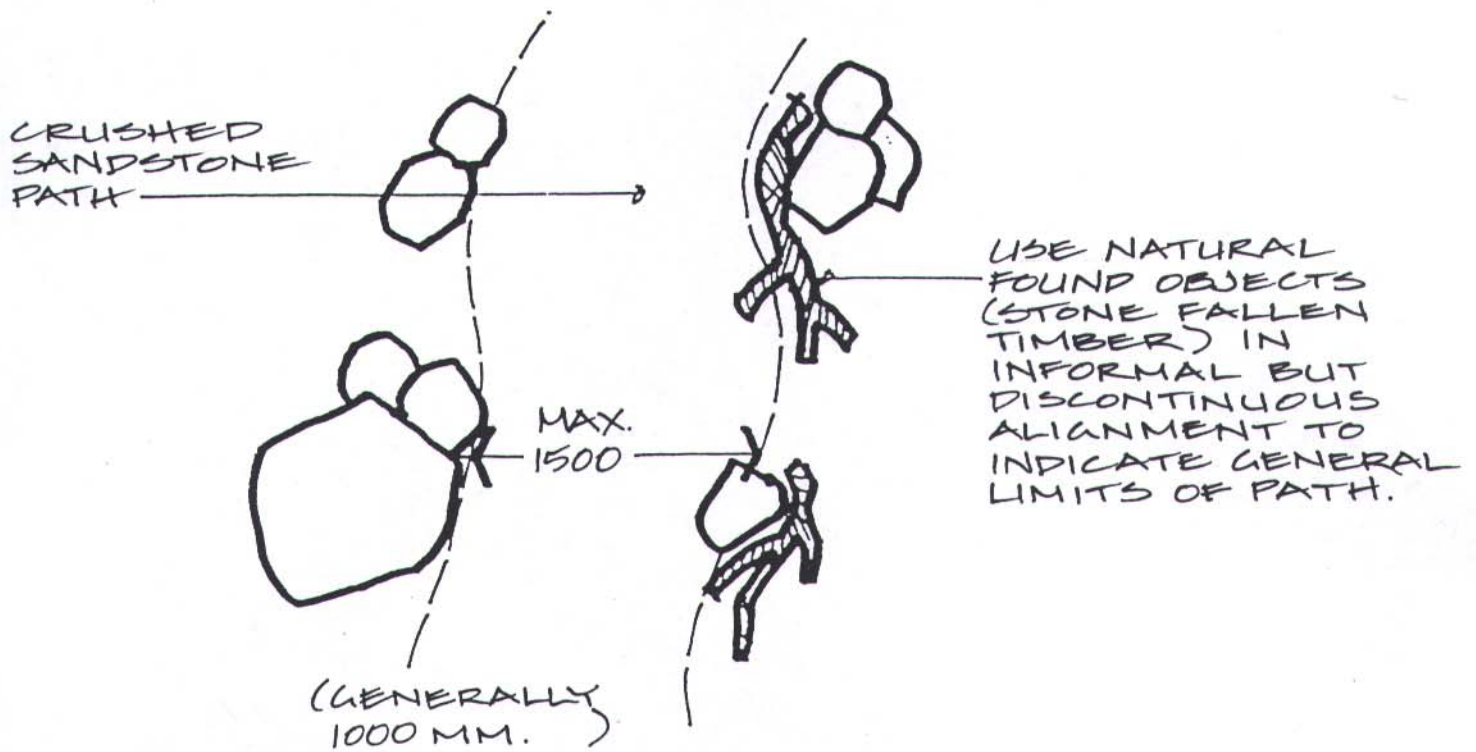

FIGURE 16
PRINCIPLES OF STORMWATER
DIVERSION FROM NATIVE
BUSHLAND



- * GENERAL NOTES: - FOR UPSLOPE PLANTING WEED CONTROL (FOLLOW REVEGETATION PROCESS). IF GREATER THAN 1:4 USE COCONUT MAT, OTHERWISE LEAF MULCH, WITH TUBESTOCK PREFERABLY.
- ALL BANK STABILISATION TREATMENTS ARE SUBJECT TO DETAILED INVESTIGATION AND DESIGN.
- FLAG LOCATIONS WHERE BANK INSTABILITY OCCURS IN CONJUNCTION WITH ADJACENT LAND MANAGER.

**FIGURE 17
STABILISATION TREATMENT OF
CREEK BANKS, VEGETATION
MANAGEMENT**



PATH CONSTRUCTED IN INERT CRUSHED SANDSTONE MIXED SIZE 35 MM Ø SAND. LAY DRY, RAKE OUT, WET & COMPACT BY HAND.

FIGURE 10
DESIGN CONCEPT FOR
STABILISED PATH IN AREAS
PRONE TO EROSION