

Quarantine Station
Detailed Area Conservation Management Plans
Archaeological Data Sheet

Precinct:

Archaeological Site ID#:

ADMINISTRATION

FEATURE NAME

ALL DEMOLISHED BUILDINGS/FEATURES IN THIS AREA ARE LISTED BELOW BY BUILDING NO, NAME AND ACHAEOLOGICAL AREA (IF KNOWN).

A3 TEMP STAFF BEDROOMS

A4 STAFF KITCHENS

A19 LOCKER SHED TO REAR OF A1 OFFICE

A24 LONG SHED

A24A UNKNOWN BUILDING TO REAR OF A24

A24B BUILDING EXTENSION TO NORTH OF A24

A27 OIL STORE NEAR LOCO SHED

A28A SMALL BUILDING TO REAR OF A28

A29 CARPENTERS SHOP (FORMER POST OFFICE)

A51 UNKNOWN SMALL BUILDING - WCS?

A52 TELEPHONE OFFICE

S1A OUTBUILDING TO S1

S4A OUTBUILDINGS IN S4 YARD (3 IN 1929)

S5B OUTBUILDING TO S5

S5C SHED IN REAR YARD OF S5 (1929)

S6A OUTHOUSE FOR S6?

S6B OUTBUILDING FOR S6 (1929)

S6C OUTBUILDING FOR S6 (1929)

S6D FOWL RUN AND SHED TO S6 (1929)

S6E OUTBUILDING TO SOUTH OF S6 (DISPENSARY IN 1929)

S6F LARGE OUTBUILDING FOR S6

S6G WC

S6H GARAGE

S7 STAFF COTTAGE (GATEKEEPERS COTTAGE)

S7A OUTBUILDING TO S7

S8 STAFF COTTAGE

S8A SHED TO SIDE OF S8

S10A OUTBUILDING TO S10

S12A OUTBUILDING (FOWL RUN) TO S12

S12B HEARSE SHED (BEHIND S12 YARD)

S14B OUTBUILDINGS TO S14

S18 STORE/COTTAGE?

S18A OUTBUILDINGS TO S18

S22 UNKNOWN BUILDING

S24 STORE BUILDING TO REAR OF S8 (GARAGE? 1929)

S24A GARAGE TO REAR OF S8 (POSSIBLY S24)

S25 SMALL UNKNOWN BUILDING NEAR A24

L2A PUMPHOUSE FOR RESERVOIR

L7 FUNICULAR TURNTABLE

L20 FUNICULAR

Thorp's Site ID

NA

Associated Features

NA

DESCRIPTION

Quarantine Station

Detailed Area Conservation Management Plans

Archaeological Data Sheet

Precinct:

Archaeological Site ID#:

ADMINISTRATION

This is a consolidated list of all the former buildings/features located in the Administration Precinct.

SIGNIFICANCE

State Themes

Transportation, Migration, Health and Technology

Assessment of Significance

If deposits or structural remains are intact they are likely to range from low to high significance.

POLICY

Endorsed Policies - QSCMP 2000

Archaeological Evidence Policy No.1
Archaeological Heritage

Archaeological Evidence Policy No.3
Historical Archaeological Relics

AMP Policies - QSCMP 2000
Policy No 3
Managing in Accordance with the AMP

The process for managing archaeological resources at the Quarantine Station is set out in this archaeological management plan. It is to be followed in all circumstances where there is a potential development impact upon the archaeological resource.

Strategy

Integrate the AMP into development assessment and determination processes.
Allocate resources to implement critical parts of the AMP.

AMP3.1

The management of all archaeological resources in the core areas should be in accordance with the AMP, especially in regard to proposed redevelopment and/or conservation works. In summary this means that where works are proposed which may affect archaeological deposits or features in or under standing structures, on demolished building sites or in designated zones of archaeological potential, the following actions must occur.

1. Undertake an Archaeological Assessment in accordance with the NSW Heritage Office Archaeological Assessments Manual.
2. Prepare a Research Design in line with the AMP requirements.
3. Obtain consent through the NPWS Manager, Cultural Heritage Division.
4. Undertake archaeological work in accordance with all permit conditions and ensure that the archaeological management process specified in the AMP is followed.

REFERENCES

Location in Main Report

See Volume 1 Table 8 Areas Aa - Ai

Refer to Figure

Quarantine Station
Detailed Area Conservation Management Plans
Archaeological Data Sheet

Precinct:

Archaeological Site ID#:

ADMINISTRATION

Illustration 8: Site Development Plan 7 - Existing and Former Buildings

Illustration 10: Areas of Archaeological Potential

Quarantine Station Detailed Area Conservation Management Plans Archaeological Data Sheet

Precinct:

Archaeological Site ID#:

ADMINISTRATION

FEATURE NAME

FEATURE TYPE: TIMBER PIPE CULVERT

Thorp's Site ID

NA

Associated Features

Remnant funicular embankments and line L20a-c

DESCRIPTION

The end of timber-pipe culvert is visible near the Locomotive Engine Shed (A18)

SIGNIFICANCE

State Themes

Utilities, Labour

Assessment of Significance

This type of culvert is one of a number at the Quarantine Station.

The timber-pipe culvert is of considerable significance due to its rarity value. It may also have technical significance and research potential.

POLICY

Endorsed Policies - QSCMP 2000

Archaeological Evidence Policy No.1
Archaeological Heritage

Archaeological Evidence Policy No.3
Historical Archaeological Relics

AMP Policies - QSCMP 2000

Policy No 3

Managing in Accordance with the AMP

The process for managing archaeological resources at the Quarantine Station is set out in this archaeological management plan. It is to be followed in all circumstances where there is a potential development impact upon the archaeological resource.

Strategy

Integrate the AMP into development assessment and determination processes.

Allocate resources to implement critical parts of the AMP.

AMP3.1

The management of all archaeological resources in the core areas should be in accordance with the AMP, especially in regard to proposed redevelopment and/or conservation works. In summary this means that where works are proposed which may affect archaeological deposits or features in or under standing structures, on demolished building sites or in designated zones of archaeological potential, the following

Quarantine Station Detailed Area Conservation Management Plans Archaeological Data Sheet

Precinct:

Archaeological Site ID#:

ADMINISTRATION

structures, on demolished building sites or in designated zones of archaeological potential, the following actions must occur.

1. Undertake an Archaeological Assessment in accordance with the NSW Heritage Office Archaeological Assessments Manual.
2. Prepare a Research Design in line with the AMP requirements.
3. Obtain consent through the NPWS Manager, Cultural Heritage Division.
4. Undertake archaeological work in accordance with all permit conditions and ensure that the archaeological management process specified in the AMP is followed.

8.7.2 Conservation and Management Policy Issues : Site Works - QSCMP 2000

REFERENCES

Location in Main Report

see Volume 1 Table 8

Refer to Figure

Illustration 11 Areas of Archaeological Significance

Quarantine Station

Detailed Area Conservation Management Plans

Archaeological Data Sheet

Precinct:

Archaeological Site ID#:

ADMINISTRATION ALSO IN OTHER AREAS

FEATURE NAME

FEATURE TYPE: BITUMEN AND ASPHALT PATHS

Thorp's Site ID

NA

Associated Features

NA

DESCRIPTION

Bitumen and asphalt paths occur at various locations around the site. They are generally used for pedestrian access between buildings. They are constructed from bitumen and asphalt and sometimes feature brick or stone edging. The latter may be remnants of earlier paths in the same location. Earlier surfaces may be extant beneath the present paths.

SIGNIFICANCE

State Themes

Utilities, Labour

Assessment of Significance

These types of paths are two of a number at the Quarantine Station.

While individually they are not of high significance in their own right, considered collectively their variety provides a picture of development over a considerable time.

POLICY

Endorsed Policies - QSCMP 2000

Archaeological Evidence Policy No.1
Archaeological Heritage

Archaeological Evidence Policy No.3
Historical Archaeological Relics

AMP Policies - QSCMP 2000

Policy No 3

Managing in Accordance with the AMP

The process for managing archaeological resources at the Quarantine Station is set out in this archaeological management plan. It is to be followed in all circumstances where there is a potential development impact upon the archaeological resource.

Strategy

Integrate the AMP into development assessment and determination processes.

Allocate resources to implement critical parts of the AMP.

AMP3.1

The management of all archaeological resources in the core areas should be in accordance with the AMP, especially in regard to proposed redevelopment and/or conservation works. In summary this means that

Quarantine Station

Detailed Area Conservation Management Plans

Archaeological Data Sheet

Precinct:

Archaeological Site ID#:

ADMINISTRATION ALSO IN OTHER AREAS

where works are proposed which may affect archaeological deposits or features in or under standing structures, on demolished building sites or in designated zones of archaeological potential, the following actions must occur.

1. Undertake an Archaeological Assessment in accordance with the NSW Heritage Office Archaeological Assessments Manual.
2. Prepare a Research Design in line with the AMP requirements.
3. Obtain consent through the NPWS Manager, Cultural Heritage Division.
4. Undertake archaeological work in accordance with all permit conditions and ensure that the archaeological management process specified in the AMP is followed.

8.7.2 Conservation and Management Policy Issues : Site Works - QSCMP 2000

REFERENCES

Location in Main Report

see Volume 1 Table 8

Refer to Figure

Illustration 11 Areas of Archaeological Significance

Quarantine Station Detailed Area Conservation Management Plans Archaeological Data Sheet

Precinct:

Archaeological Site ID#:

ADMINISTRATION ALSO IN OTHER AREAS

FEATURE NAME

FEATURE TYPE: STONE ROAD EDGES

Thorp's Site ID

Associated Features

Stone paved road gutters, stone paved roads

DESCRIPTION

Some of the roads have stone edging to define and retain the road edges - especially in grassed areas. These are constructed of small flat blocks of rectangular sandstone laid end to end.

These edges may be remnants of earlier stone paved roads which have been covered by asphalt or bitumen.

SIGNIFICANCE

State Themes

Utilities, Labour

Assessment of Significance

This type of road edging is one of a number at the Quarantine Station.

While individually they are not of high significance, considered collectively their variety provides a picture of development over a considerable time.

The use of sandstone may indicate that this is an earlier edging treatment or related to an early road alignment.

POLICY

Endorsed Policies - QSCMP 2000

Archaeological Evidence Policy No.1
Archaeological Heritage

Archaeological Evidence Policy No.3
Historical Archaeological Relics

AMP Policies - QSCMP 2000

Policy No 3

Managing in Accordance with the AMP

The process for managing archaeological resources at the Quarantine Station is set out in this archaeological management plan. It is to be followed in all circumstances where there is a potential development impact upon the archaeological resource.

Strategy

Integrate the AMP into development assessment and determination processes.

Allocate resources to implement critical parts of the AMP.

Quarantine Station Detailed Area Conservation Management Plans Archaeological Data Sheet

Precinct:

Archaeological Site ID#:

ADMINISTRATION ALSO IN OTHER AREAS

AMP3.1

The management of all archaeological resources in the core areas should be in accordance with the AMP, especially in regard to proposed redevelopment and/or conservation works. In summary this means that

where works are proposed which may affect archaeological deposits or features in or under standing structures, on demolished building sites or in designated zones of archaeological potential, the following actions must occur.

1. Undertake an Archaeological Assessment in accordance with the NSW Heritage Office Archaeological Assessments Manual.
2. Prepare a Research Design in line with the AMP requirements.
3. Obtain consent through the NPWS Manager, Cultural Heritage Division.
4. Undertake archaeological work in accordance with all permit conditions and ensure that the archaeological management process specified in the AMP is followed.

8.7.2 Conservation and Management Policy Issues : Site Works - QSCMP 2000

MINIMUM STANDARDS FOR ARCHAEOLOGICAL RESOURCES

Exposure does not require archaeological involvement.

If to be replaced then sampling of fabric must occur.

REFERENCES

Location in Main Report

see Volume 1 Table 8

Refer to Figure

Illustration 11 Areas of Archaeological Significance

Quarantine Station

Detailed Area Conservation Management Plans

Archaeological Data Sheet

Precinct:

Archaeological Site ID#:

ADMINISTRATION

1C/6

FEATURE NAME

EXTANT FEATURE: CONCRETE CAPPED DRAIN OUTLET

Thorp's Site ID

NA

Associated Features

P1, A28

DESCRIPTION

This drain is located between building A28 and P1. It is a large drain outlet which is covered with a 1.4m x 0.3m worked sandstone block. The block rests on the ground surface and is supported by the coursed sandstone walls of the drain outlet. The cavity beneath the sandstone cap is approx 0.9m high x 0.8m wide.

The drain consists of 10 segments of terracotta pipe, joined and slightly angled in an easterly direction. The pipe terminates at what appears to be bedrock. It is possible that an extension of this drain exists and has been formed out of the sandstone bedrock. Access and poor light restricted further inspection of this component of the drain.

This feature also consists of an open sandstone drain which extends out in a westerly direction past the footings of building A28. At this point the drain terminates and the water runs into the surrounding lawn area.

This drain complex is in a sound condition, but the coursed sandstone walls which support the large sandstone cap appear to have been subject to subsidence. Many of the sandstone blocks have moved slightly out of their original position.

SIGNIFICANCE

State Themes

Utilities

Assessment of Significance

This type of drain is one of a number at the Quarantine Station. While individually they are not of high significance, considered collectively their variety provides a picture of development over time.

POLICY

Endorsed Policies - QSCMP 2000

Archaeological Evidence Policy No.1
Archaeological Heritage

Archaeological Evidence Policy No.3
Historical Archaeological Relics

AMP Policies - QSCMP 2000
Policy No 3

Managing in Accordance with the AMP

The process for managing archaeological resources at the Quarantine Station is set out in this

1C/6

Quarantine Station Detailed Area Conservation Management Plans Archaeological Data Sheet

Precinct:

Archaeological Site ID#:

ADMINISTRATION

1C/6

archaeological management plan. It is to be followed in all circumstances where there is a potential development impact upon the archaeological resource.

Strategy

Integrate the AMP into development assessment and determination processes.
Allocate resources to implement critical parts of the AMP.

AMP3.1

The management of all archaeological resources in the core areas should be in accordance with the AMP, especially in regard to proposed redevelopment and/or conservation works. In summary this means that where works are proposed which may affect archaeological deposits or features in or under standing structures, on demolished building sites or in designated zones of archaeological potential, the following actions must occur.

1. Undertake an Archaeological Assessment in accordance with the NSW Heritage Office Archaeological Assessments Manual.
2. Prepare a Research Design in line with the AMP requirements.
3. Obtain consent through the NPWS Manager, Cultural Heritage Division.
4. Undertake archaeological work in accordance with all permit conditions and ensure that the archaeological management process specified in the AMP is followed.

8.7.2 Conservation and Management Policy Issues : Site Works - QSCMP 2000

MINIMUM STANDARDS FOR ARCHAEOLOGICAL RESOURCES

Exposure does not require archaeological involvement.
If to be replaced than sampling of fabric

REFERENCES

Location in Main Report

See Volume 1: Table 8 Area Ak

Refer to Figure

Illustration 8: Site Development Plan 7 - Existing and Former Buildings

Illustration 10: Areas of Archaeological Potential

Illustration 11: Areas of Archaeological Significance

1C/6

Quarantine Station
Precinct Conservation Management Plan
Building and Feature Data Sheets

Precinct:
ADMINISTRATION

Building Name:
LOWER RESERVOIR

Building Number:
L02

LOCATION PLAN

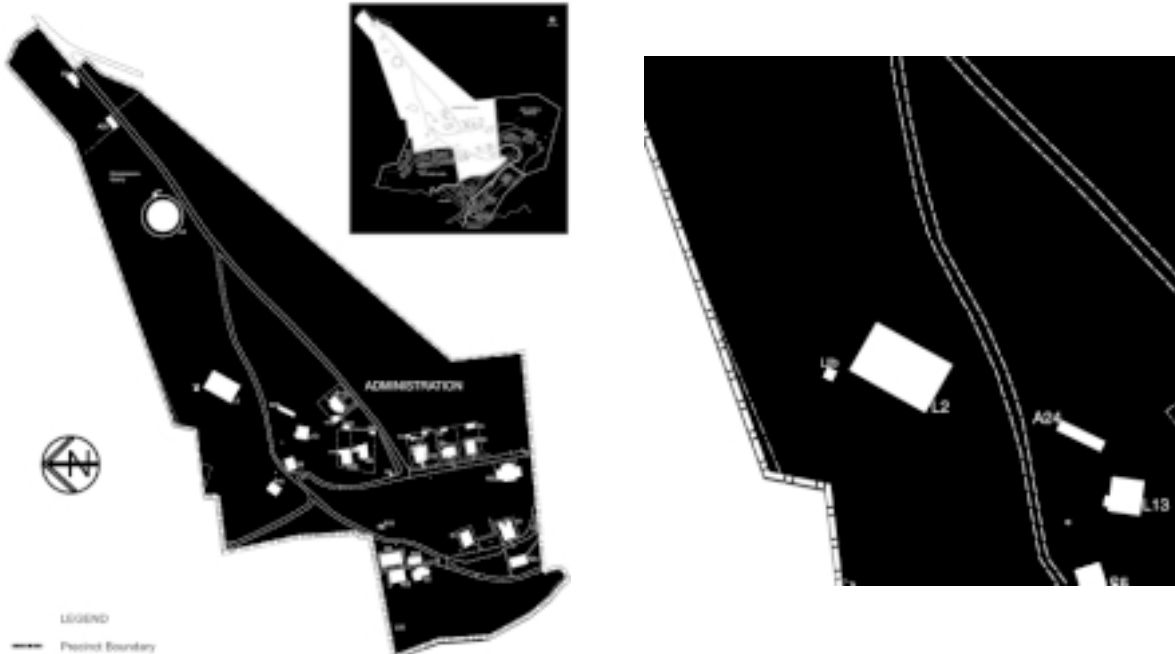

P Davies 2001



P Davies 2001



P Davies 2001

L02

Quarantine Station

Detailed Area Conservation Management Plans

Building Data Sheet

Precinct:

Building Name:

Building Number:

ADMINISTRATION

RESERVOIR

L02

HISTORICAL BACKGROUND

The reservoir was constructed by 1884, appearing on site plan 85/QS M1504 but not on the 1882 site plan. It was constructed on the high ground above the recently completed 1st Class area, presumably to allow it to gravity feed to bathrooms and kitchen areas. It was constructed by excavating a large rectangular hole. It is concrete lined, and is now roofed. The roof appears to have been constructed to improve the water quality.

FABRIC CHANGES

Constructed c1884

Roof covering added c1960

SIGNIFICANCE

| Assessment of Significance | overall | historic | aesthetic | social | research | archaeological potential | rarity | representativeness |
|----------------------------|---------|----------|-----------|--------|----------|--------------------------|--------|--------------------|
| based on SHI criteria | 2 | 2 | 3 | 3 | 3 | LOW | NO | YES |

State Themes

Utilities

Government and Administration

Statement of significance

The reservoir is an important structure on the site as it allowed the site to function with a ready supply of fresh water. Its introduction early in the Board of Health Phase of site occupation marked an improvement in the site services, along with the provision of new amenities buildings and the extensive building program that ensued. The provision of fresh water was an essential part of the healthy operation of the site.

The structure has historic significance as the first major reservoir on the site; for its construction and reticulation systems; and its role in the provision of a healthy environment.

It has limited aesthetic significance particularly with the present roof structure.

It has some research significance for its construction and the reticulation systems related to it.

POLICY

Potential uses

The structure can only function as a reservoir and it is recommended that it continue to provide additional water for the site only for fire fighting and general emergency supply. The main water supply for the Station is now provided from mains reticulation.

Fabric to be retained

L02

**Quarantine Station
Detailed Area Conservation Management Plans
Building Data Sheet**

Precinct:

Building Name:

Building Number:

ADMINISTRATION

RESERVOIR

L02

The reservoir structure, its associated pipework and infrastructure should be retained.

Adaptation

The roof structure may be adapted to replace the present AC cladding with a more appropriate material. Extreme care should be exercised in removal of the cladding to prevent Asbestos entering the water supply. The roof structure and a form of compatible cladding should be retained.

The fence may be replaced with new security fencing of similar style.

BUILDING DESCRIPTION AND CONDITION

Description

The reservoir is a rectangular concrete pit with an AC clad roof and gable ends. The roof structure is steel tube and angle trusses sitting on the concrete base. There is a timber pass door in one gable that has fallen off its hinges. There is pipework, float levels, inlet and outlet valves and ladder access into the well area. It is currently about 75% full of water.

The area is secured by a wire fence that is accessible without keys, consequently providing a security hazard, particularly as access is available to the water area.

BCA Constraints

NA

Roof Cladding

Materials: Corrugated AC sheet
Condition: Fair

Consider replacement to prevent risk of material entering water supply.

Floors

Materials: NA
Condition:

Internal Walls

Materials: Concrete
Condition:

Currently under water appears in fair condition.

Ceilings

Materials: NA
Condition:

NA

Fittings

L02

Quarantine Station
Detailed Area Conservation Management Plans
Building Data Sheet

Precinct:

ADMINISTRATION

Building Name:

RESERVOIR

Building Number:

L02

NA

Doors and Windows

Materials Timber door

Condition:

Poor condition requires repair.

Electrical fitout

Condition: NA

NA

Plumbing and Drainage

Condition: Poor

The condition of pipework is not known. It appears that water can be removed from the reservoir.

External Elements

NA

Immediate site conditions

The site within the fenced area is subject to regrowth. This has obscured the structure from the entry road which is desirable. There are remnants of steps and retaining structures between the reservoir and pump house. These are in poor condition. Surface pipework is evident around the structure.

The perimeter fence requires some repair and securing.

MAINTENANCE ASSESSMENT

Urgent work: 0 - 1 year

- 1 Repair and lock door to reservoir
- 2 Check operational status of equipment
- 3 Clear access path to reservoir
- 4 Secure perimeter fence

Medium term work: 1 - 3 years

- 1 Test water for quality of supply
- 2 Replace roof and wall cladding or seal to prevent contamination

Long term work: 3 - 5 years

L02

Quarantine Station
Detailed Area Conservation Management Plans
Building Data Sheet

Precinct:

ADMINISTRATION

Building Name:

RESERVOIR

Building Number:

L02

1 Check adequacy of structure when empty, clean as required and carry out repairs

DRAWINGS

NA

L02

Quarantine Station
Precinct Conservation Management Plan
Building and Feature Data Sheets

Precinct:
ADMINISTRATION

Building Name:
LOWER PUMP HOUSE

Building Number:
L02b

LOCATION PLAN

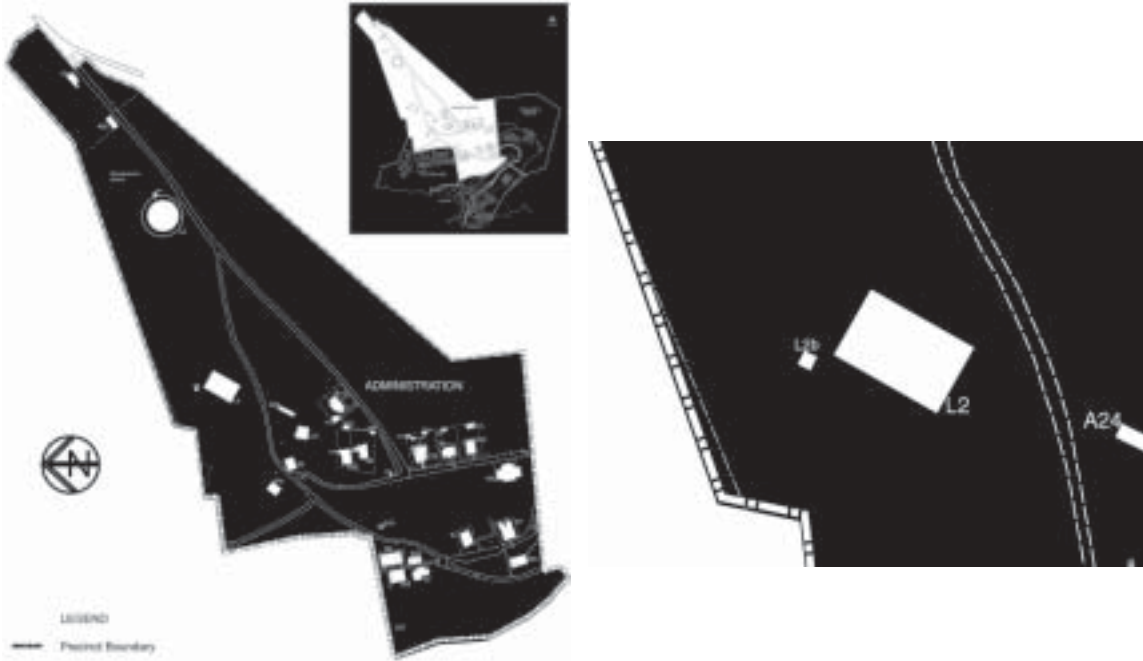

P Davies 2001

L02b

Quarantine Station
Precinct Conservation Management Plan
Building and Feature Data Sheets

Precinct:

ADMINISTRATION

Building Name:

LOWER RESERVOIR

Building Number:

L02



P Davies 2001



P Davies 2001



P Davies 2001



P Davies 2001

L02

Quarantine Station Detailed Area Conservation Management Plans Building Data Sheet

Precinct:

ADMINISTRATION

Building Name:

RESERVOIR PUMP HOUSE

Building Number:

L02b

HISTORICAL BACKGROUND

This small shed first appears on a site plan in 1950. As there is a gap in plans between 1929 and 1950 and it does not appear on the 1929 site plans, the construction date is likely to be in that period. The present structure replaced an earlier pump house located further down the hill (not located on site). It contains two modern pumps made by TECO Australia and the building has been refitted probably in the 1960 period and relined in recent years.

The reservoirs are no longer used as the main water supply to the site.

FABRIC CHANGES

Constructed 1929-1954

Electrical refit c 1960

Pumps replaced post 1984

Building reclad and window removed post 1984

SIGNIFICANCE

| Assessment of Significance | overall | historic | aesthetic | social | research | archaeological potential | rarity | representativeness |
|----------------------------|---------|----------|-----------|--------|----------|--------------------------|--------|--------------------|
| based on SHI criteria | 2 | 2 | 3 | 3 | 3 | LOW | NO | YES |

State Themes

Utilities

Statement of significance

The building is significant as part of the infrastructure of the Station. Given its high level of alteration the fabric does not have high significance. The location and form of the building are however significant to understanding the operation of the place.

None of the present equipment in the building is of particular significance, however it does demonstrate the frequency of change to the service elements of the place.

POLICY

Potential uses

The building has limited use and should continue in use to house any pump equipment required for the reservoir.

Fabric to be retained

The basic structure of the place and the surviving door should be retained in future work.

Adaptation

L02b

Quarantine Station Detailed Area Conservation Management Plans Building Data Sheet

Precinct:

ADMINISTRATION

Building Name:

RESERVOIR PUMP HOUSE

Building Number:

L02b

Despite the level of change to the cladding and the removal of the window, it would be appropriate to reinstate the window and claddings to the original form. As the cladding has recently been replaced it would be acceptable to make this change when the cladding requires maintenance.

BUILDING DESCRIPTION AND CONDITION

Description

The building is small, rectangular with a concrete floor with perimeter edge beam onto which the frame is built. The frame appears original but the cladding is recent fixed on steel top hat sections, the window has been removed (framing indicates its location) and a translucent sheet fixed to provide light. The solid core door is in poor condition and has a bolt fixing.

The building is in poor overall condition despite the recent recladding.

BCA Constraints

NA

Roof Cladding

Materials Corrugated Iron Sheet

Condition:

Recently replaced. No gutters.

Floors

Materials Concrete

Condition: Fair

Fair condition

Internal Walls

Materials Unlined

Condition:

Ceilings

Materials NA

Condition:

NA

Fittings

Electrical fitout. 2 TECO pumps.

Doors and Windows

Materials Solid core door

L02b

Quarantine Station
Detailed Area Conservation Management Plans
Building Data Sheet

Precinct:

ADMINISTRATION

Building Name:

RESERVOIR PUMP HOUSE

Building Number:

L02b

Condition: Deteriorated

Door requires replacement and securing.

Electrical fitout

Condition: Poor

The switchboard and wiring is c1960 fitout.

Plumbing and Drainage

Condition: NA

NA

External Elements

External claddings are new. Exposed timberwork to eaves and roof is poor requiring maintenance.

Immediate site conditions

There is a build up of material around the building that requires clearing. The steps and path have deteriorated making access difficult.

MAINTENANCE ASSESSMENT

Urgent work: 0 - 1 year

- 1 Clear around building and provide drainage access.
- 2 Check electrical system and repair as required
- 3 Replace entry door and lock
- 4 Paint exterior timberwork

Medium term work: 1 - 3 years

NA

Long term work: 3 - 5 years

- 1 Reclad and reinstate window - long term

DRAWINGS

NA

L02b

Quarantine Station
Detailed Area Conservation Management Plans
Archaeological Data Sheet

Precinct:

Archaeological Site ID#:

ADMINISTRATION

L02b

FEATURE NAME

EXTANT BLDG: L02B CURRENT PUMP HOUSE

Thorp's Site ID

NA

Associated Features

L02

DESCRIPTION

Concrete floor. Sub floor non-existent.

SIGNIFICANCE

State Themes

Utilities

Assessment of Significance

Low

POLICY

Endorsed Policies - QSCMP 2000

Archaeological Evidence Policy No.1
Archaeological Heritage

Archaeological Evidence Policy No.3
Historical Archaeological Relics

AMP Policies - QSCMP 2000

Policy No 3

Managing in Accordance with the AMP

The process for managing archaeological resources at the Quarantine Station is set out in this archaeological management plan. It is to be followed in all circumstances where there is a potential development impact upon the archaeological resource.

Strategy

Integrate the AMP into development assessment and determination processes.

Allocate resources to implement critical parts of the AMP.

AMP3.1

The management of all archaeological resources in the core areas should be in accordance with the AMP, especially in regard to proposed redevelopment and/or conservation works. In summary this means that where works are proposed which may affect archaeological deposits or features in or under standing structures, on demolished building sites or in designated zones of archaeological potential, the following actions must occur.

1. Undertake an Archaeological Assessment in accordance with the NSW Heritage Office Archaeological Assessments Manual.

2. Prepare a Research Design in line with the AMP requirements.

L02b

Quarantine Station Detailed Area Conservation Management Plans Archaeological Data Sheet

Precinct:

Archaeological Site ID#:

ADMINISTRATION

L02b

2. Prepare a Research Design in line with the AMP requirements.
3. Obtain consent through the NPWS Manager, Cultural Heritage Division.
4. Undertake archaeological work in accordance with all permit conditions and ensure that the archaeological management process specified in the AMP is followed.

Note comment in AMP that cemeteries are of the highest significance and should generally be embargoed from invasive archaeological research and any development. (AMP: 8)

MINIMUM STANDARDS FOR ARCHAEOLOGICAL RESOURCES

Standing buildings

- Measured drawing prior to alteration
- Recording of all surface treatments
- Harris matrix of structural/finish evolution
- Sampling of fabric
- Examination for inscriptions

REFERENCES

Location in Main Report

See Volume 1 Table 9

Refer to Figure

Illustration 8: Site Development Plan 7 - Existing and Former Buildings

Illustration 10: Areas of Archaeological Potential

L02b

Quarantine Station
Precinct Conservation Management Plan
Building and Feature Data Sheets

Precinct:

ADMINISTRATION

Building Name:

UPPER RESERVOIR

Building Number:

L08

LOCATION PLAN

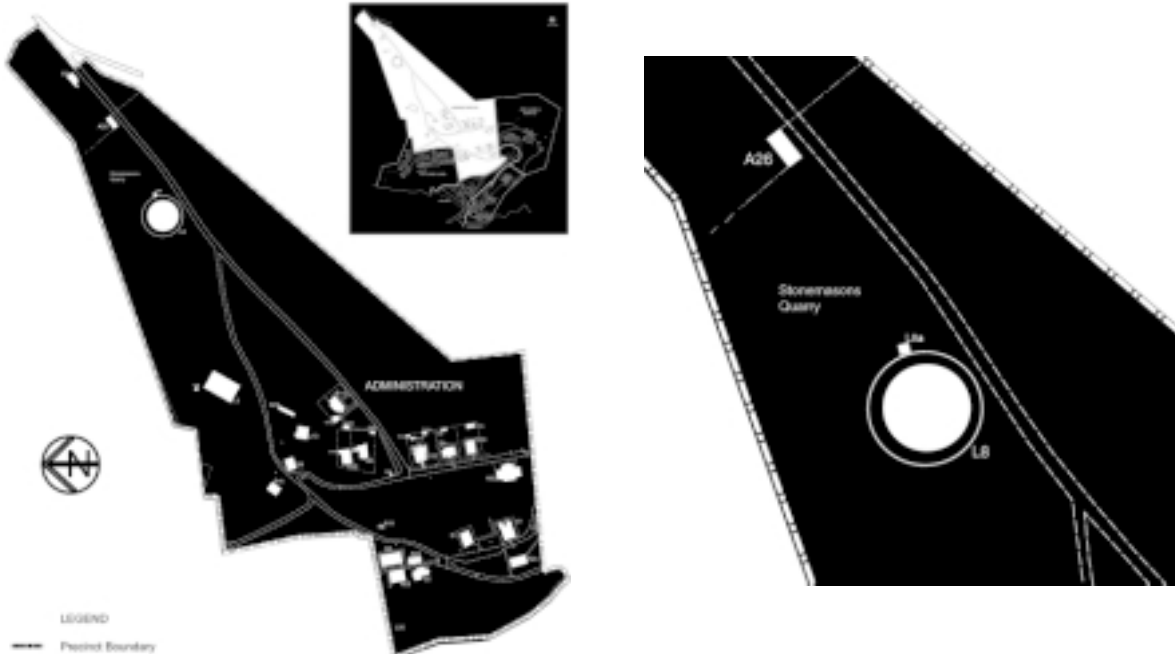

P Davies 2001



P Davies 2001

L08

Quarantine Station Detailed Area Conservation Management Plans Building Data Sheet

Precinct:

Building Name:

Building Number:

ADMINISTRATION

RESERVOIR

L08

HISTORICAL BACKGROUND

The reservoir was constructed by 1911 first appearing on a site plan of that date. It was constructed at a higher level to the first reservoir but also adjacent to the entry road. It was and remains an open structure, fenced with a small brick pump house adjacent.

FABRIC CHANGES

Constructed c1911

SIGNIFICANCE

| Assessment of Significance <small>based on SHI criteria</small> | overall | historic | aesthetic | social | research | archaeological potential | rarity | representativeness |
|--|---------|----------|-----------|--------|----------|--------------------------|--------|--------------------|
| | 2 | 2 | 3 | 3 | 3 | LOW | NO | YES |

State Themes

Utilities

Government and Administration

Statement of significance

The reservoir is an important structure on the site as it allowed the site to function with a ready supply of fresh water. Its addition to the site at a time of expansion of the facilities reflects both medical practice and the reliance on water for peak occupation of the station. The provision of fresh water was an essential part of the healthy operation of the site.

The structure has historic significance as the second major reservoir on the site; for its construction and reticulation systems; and its role in the provision of a healthy environment.

It has aesthetic significance for its picturesque form in the landscape.

It has some research significance for its construction and the reticulation systems related to it.

POLICY

Potential uses

The structure can only function as a reservoir and it is recommended that it continue to provide additional water for the site only for fire fighting and general emergency supply. The main water supply for the Station is now provided from mains reticulation.

Fabric to be retained

The reservoir structure, its associated pipework and infrastructure should be retained.

The site should continue to be fenced with a security fence.

L08

Quarantine Station
Detailed Area Conservation Management Plans
Building Data Sheet

Precinct:

ADMINISTRATION

Building Name:

RESERVOIR

Building Number:

L08

Adaptation

The fence may be replaced with new security fencing of similar style.

BUILDING DESCRIPTION AND CONDITION

Description

The reservoir is a circular concrete lined structure with sloping sides. It is built slightly into the hill and is built up with a dam wall across the slope. At the low point of the site there is a spillway and pumping apparatus that is no longer functional.

The area is secured by a wire fence that is accessible without keys, consequently providing a security hazard, particularly as access is available to the water area.

BCA Constraints

NA

Roof Cladding

Materials: NA
Condition: NA

NA

Floors

Materials: NA
Condition: NA

NA

Internal Walls

Materials: Concrete
Condition:

Currently under water appears in fair condition.

Ceilings

Materials: NA
Condition: NA

NA

Fittings

NA

L08

Quarantine Station
Detailed Area Conservation Management Plans
Building Data Sheet

Precinct:

ADMINISTRATION

Building Name:

RESERVOIR

Building Number:

L08

Doors and Windows

Materials: NA

Condition: NA

NA

Electrical fitout

Condition: NA

NA

Plumbing and Drainage

Condition: Poor

The condition of pipework is not known. It appears that water can be removed from the reservoir.

External Elements

NA

Immediate site conditions

The site within the fenced area is subject to regrowth. This has obscured the dam from the entry road which is not desirable. Surface pipework is evident around the structure.

The perimeter fence requires some repair and securing.

MAINTENANCE ASSESSMENT

Urgent work: 0 - 1 year

1 Clear access path to reservoir

2 Secure perimeter fence

Medium term work: 1 - 3 years

1 Test water for quality of supply

Long term work: 3 - 5 years

1 Check adequacy of structure when empty, clean as required and carry out repairs

2 Cyclical checking and cleaning depending on use of water.

DRAWINGS

NA

L08

Quarantine Station
Precinct Conservation Management Plan
Building and Feature Data Sheets

Precinct:
ADMINISTRATION

Building Name:
PUMP HOUSE 2

Building Number:
L8a

LOCATION PLAN

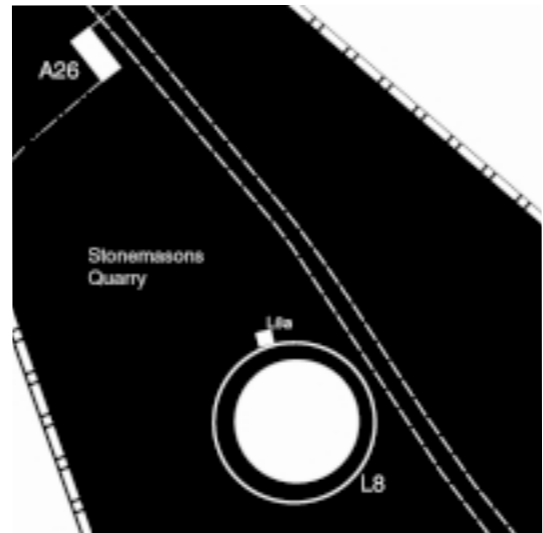
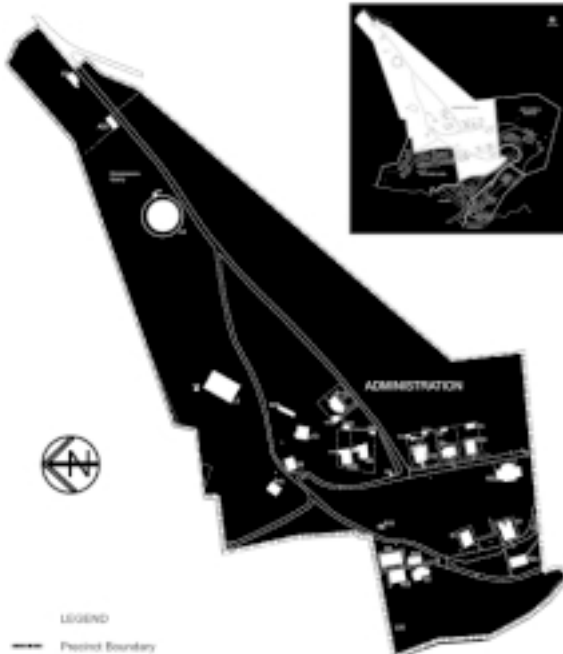

P Davies 2000



P Davies 2000

Quarantine Station Detailed Area Conservation Management Plans Building Data Sheet

Precinct:

ADMINISTRATION

Building Name:

PUMP HOUSE 2

Building Number:

L08a

HISTORICAL BACKGROUND

The second reservoir first appears on site plans in 1911 and the pumphouse in 1950. The building however appears to predate this by a considerable time, most likely early in the 20th century, and probably dates from the time of construction of the reservoir. It was built to house equipment to pump water from the upper reservoir into the supply system.

FABRIC CHANGES

Constructed c1900-1910

Roof replaced with AC corrugated sheet 1958-62

SIGNIFICANCE

| Assessment of Significance based on SHI criteria | overall | historic | aesthetic | social | research | archaeological potential | rarity | representativeness |
|---|---------|----------|-----------|--------|----------|--------------------------|--------|--------------------|
| | 3 | 3 | 3 | 3 | 2 | LOW | NO | YES |

State Themes

Utilities

Government and
Administration

Health

Statement of significance

This small building is significant as part of the services infrastructure of the Quarantine Station. It demonstrates reticulation and storage of water and current technologies seen in the pump equipment and electrical fitout.

The building, while unpretentious in design and form, is consistent with the design of the service buildings on the Station using brick walls, and timber joinery commensurate with other buildings on the site.

POLICY

Potential uses

The building is small in scale, related to the water supply and houses equipment that should remain in situ. As a result of these constraints the building is not capable of an active use and should be used for interpretation of the services aspects of the site.

Fabric to be retained

The building fabric should be retained principally in its planned form. The AC roof sheeting could be replaced with corrugated metal roofing to demonstrate the planned form as this building is remote from the main complex and retains its galvanised iron gutters and downpipes.

The internal fitout, including the pump and pipe equipment, is to be retained, as is the tool cupboard and the electrical switchboard.

L08a

Quarantine Station

Detailed Area Conservation Management Plans

Building Data Sheet

Precinct:

ADMINISTRATION

Building Name:

PUMP HOUSE 2

Building Number:

L08a

Adaptation

Adaptation is not recommended for the building.

BUILDING DESCRIPTION AND CONDITION

Description

The building is single skin face brick with engaged piers on the internal face located either side of the two windows. Access is through a panelled timber door. Both windows are boarded up but the frames survive intact.

The roof is timber framed, hipped with projecting rafters and is now clad in AC. The roof frame is tied to the walls with exposed hoop iron straps. The building has a concrete floor, a damp proof course, is painted white internally and has struck and lined joints externally.

The building is located adjacent to the second reservoir, which is a circular concrete lined structure sunk into the ground. The Pump House is located on the alignment of the chain wire fence surrounding it. The Pump House is also now surrounded by revegetated bushland which is severely encroaching on the structure causing significant maintenance problems. A former access road appears to have been located around the perimeter of the building to provide access to the double gates in the reservoir fence directly behind the structure. This road is no longer accessible or visible in the bushland.

The building overall is in fair condition considering its location and lack of use. There is however severe cracking in the front corner which requires stabilising.

The ground level around the building has built up so that soil has entered the building and has accumulated around the walls.

BCA Constraints

These do not apply to the building.

Roof Cladding

Materials Corrugated AC sheet
Condition: Fair

The roof appears to have replaced an earlier galvanised iron roof. The gutters and downpipes remain in galvanised iron. They are in poor condition and require reconnection and generally replacement. They discharge onto the ground at the base of the building.

Floors

Materials Concrete
Condition: Fair

The concrete floor survives in reasonable condition.

Internal Walls

Materials Painted brick
Condition: Deteriorated

L08a

Quarantine Station Detailed Area Conservation Management Plans Building Data Sheet

Precinct:

ADMINISTRATION

Building Name:

PUMP HOUSE 2

Building Number:

L08a

The internal painting has suffered from damp problems.

Ceilings

Materials: Nil
Condition:

Fittings

The original pump equipment is in place (type unknown) with its associated pipework. It requires oiling and painting to prevent deterioration.

The electrical switchboard c1930 survives as a very good intact example of the electrical fitout from this period.

A small tool cupboard mounted on the wall survives demonstrating a typical installation.

Doors and Windows

Materials: Timber joinery

Condition: Poor to fair

The entry door is in good condition but requires painting and urgent maintenance to prevent deterioration. The bolt is original but rusted requiring stabilisation.

The windows are double paned casements, one with casement hold-open catch. They have no glass and are boarded. They are capable of repair and restoration.

Electrical fitout

Condition: Poor

Not connected.

Plumbing and Drainage

Condition: NA

NA

External Elements

The exterior of the building, apart from cracked brickwork, is fair. Timberwork requires painting as a matter of urgency and the brickwork requires repair.

Immediate site conditions

Bush regeneration has encroached around the building causing a build up in soil around the base of the building, blocking drainage and causing damp problems. Urgent clearing of the bush around the building is required and lowering of the ground level to allow drainage away from the building.

MAINTENANCE ASSESSMENT

L08a

Quarantine Station
Detailed Area Conservation Management Plans
Building Data Sheet

Precinct:

ADMINISTRATION

Building Name:

PUMP HOUSE 2

Building Number:

L08a

Urgent work: 0 - 1 year

- 1 Remove external bush encroachment, lower the ground level around the building and ensure that gradients fall away from the building. Remove encroaching soil from within the building
- 2 Repair and repaint the windows and door, remove the temporary boarding and reglaze
- 3 Paint the other external timber elements
- 4 Secure the building with a padlock

Medium term work: 1 - 3 years

- 1 Repair the damaged brickwork
- 2 Stabilise internal equipment

Long term work: 3 - 5 years

- 1 Repaint the interior
- 2 Re-roof as required with corrugated metal profile to match original roofing

DRAWINGS

Nil

L08a

Quarantine Station
Detailed Area Conservation Management Plans
Archaeological Data Sheet

Precinct:

Archaeological Site ID#:

ADMINISTRATION

L08a

FEATURE NAME

EXTANT BLDG: L08A UPPER RESERVOIR PUMP HOUSE

Thorp's Site ID

NA

Associated Features

L08

DESCRIPTION

Concrete floor. Sub floor non-existent.

SIGNIFICANCE

State Themes

Utilities

Assessment of Significance

Low

POLICY

Endorsed Policies - QSCMP 2000

Archaeological Evidence Policy No.1
Archaeological Heritage

Archaeological Evidence Policy No.3
Historical Archaeological Relics

AMP Policies - QSCMP 2000

Policy No 3

Managing in Accordance with the AMP

The process for managing archaeological resources at the Quarantine Station is set out in this archaeological management plan. It is to be followed in all circumstances where there is a potential development impact upon the archaeological resource.

Strategy

Integrate the AMP into development assessment and determination processes.

Allocate resources to implement critical parts of the AMP.

AMP3.1

The management of all archaeological resources in the core areas should be in accordance with the AMP, especially in regard to proposed redevelopment and/or conservation works. In summary this means that where works are proposed which may affect archaeological deposits or features in or under standing structures, on demolished building sites or in designated zones of archaeological potential, the following actions must occur.

1. Undertake an Archaeological Assessment in accordance with the NSW Heritage Office Archaeological Assessments Manual.
2. Prepare a Research Design in line with the AMP requirements.

L08a

Quarantine Station Detailed Area Conservation Management Plans Archaeological Data Sheet

Precinct:

Archaeological Site ID#:

ADMINISTRATION

L08a

2. Prepare a Research Design in line with the AMP requirements.
3. Obtain consent through the NPWS Manager, Cultural Heritage Division.

4. Undertake archaeological work in accordance with all permit conditions and ensure that the archaeological management process specified in the AMP is followed.

Note comment in AMP that cemeteries are of the highest significance and should generally be embargoed from invasive archaeological research and any development. (AMP: 8)

MINIMUM STANDARDS FOR ARCHAEOLOGICAL RESOURCES

Standing buildings

- Measured drawing prior to alteration
- Recording of all surface treatments
- Harris matrix of structural/finish evolution
- Sampling of fabric
- Examination for inscriptions

REFERENCES

Location in Main Report

See Volume 1 Table 9

Refer to Figure

Illustration 8: Site Development Plan 7 - Existing and Former Buildings

Illustration 10: Areas of Archaeological Potential

L08a

Quarantine Station
Precinct Conservation Management Plan
Building and Feature Data Sheets

Precinct

Feature Name

Feature Number

ADMINISTRATION

UPPER SLOPES

L12

LOCATION PLAN

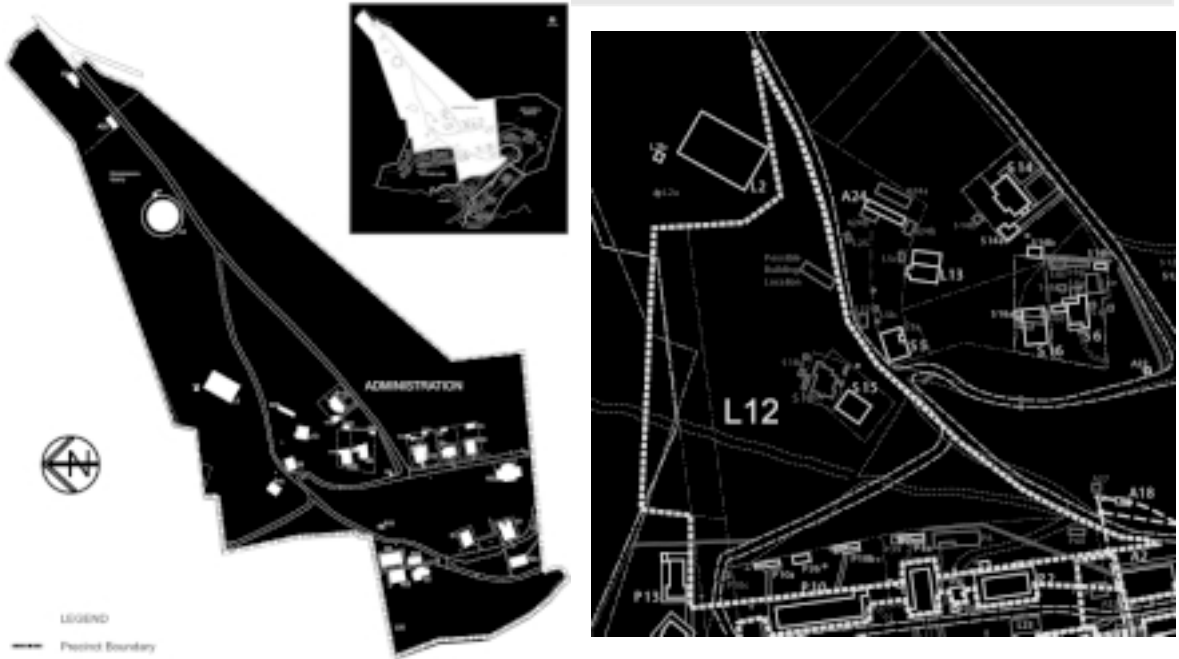

Spackman & Mossop 2000

L12

Quarantine Station
Precinct Conservation Management Plan
Building and Feature Data Sheets

Precinct

Feature Name

Feature Number

ADMINISTRATION

UPPER SLOPES

L12



Spackman & Mossop 2000



Spackman & Mossop 2000



Unknown



2000



1929

L12